

Meeting *Program*



www.thename.org

NAME 59th Annual Meeting
October 17-21, 2025

Louisville Marriott Downtown
Louisville, Kentucky





**THANK
YOU!**

To our
2025
Annual Meeting
Sponsors

Diamond Partner



NMS
LABS

Platinum Partner

FPS

FORENSIC PATHOLOGY SERVICES

Sponsors

Kim A. Collins, MD

ARTIVION™

THE
DENTON
FAMILY

MICHAEL F. RIEDERS, PHD

Table of Contents

Code of Conduct	3
Media Policy.....	3
Louisville Marriott Downtown Floorplan.....	4
Welcome to Annual Meeting	5
NAME Officers and Board of Directors.....	7
NAME Committees.....	9
CME Information	15
Meeting Program.....	17
Exhibits:	
Exhibit Schedule	39
Exhibit Hall Map	40
Participating Exhibitor Descriptions.....	41
Optional/Special Programs:	
Milton Helpern Laureate Award.....	47
The Louis Jares Celebration of Life Dance Party.....	47
Navigating Governmental Affairs and Advocacy – Breakfast Briefing	49
NAME Foundation Thomas Noguchi, MD Lecture, “Coroner to the Stars”.....	49
27 th Annual Rigor Run/Walk.....	50
30 th Annual Randy Hanzlick Memorial Cadaver Open Golf Tournament	50
Louis Jares Memorial Bring Your Own Stories Event.....	50
Learn to Lead with Integrity and Innovation from Forensic Pathology Leaders – Breakfast Workshop.....	50
Voices: Amplify, Elevate, Celebrate Luncheon.....	50
The Business of Forensic Pathology Breakfast.....	51



NAME 59th Annual Meeting
Louisville Marriott Downtown – Louisville, Kentucky
October 17 – 21, 2025

NOTES

CODE OF CONDUCT

1. The Code

As a means to promote the highest quality of professional and personal conduct of its members, the following constitutes the Code of Ethics and Conduct which is endorsed and recommended to be adhered to by all members of the Association:

A. Every member of the Association shall refrain from exercising professional or personal conduct adverse to the best interests and purposes of the Association or to the medical examiner profession.

B. No member of the Association shall materially misrepresent his or her educational training, experience, area of expertise, certification, membership status within the Association or official title or position in a medicolegal system.

C. Every member of the Association shall refrain from providing any material misrepresentation of data upon which an expert opinion or conclusion is based.

D. Except for the President and Chairperson of the Board of Directors or their designees, no member of the Association shall issue public statements that appear to represent the position of the Association.

E. All applicants for membership and annual renewal of membership shall affirm by their signatures that they have read, understood, and endorsed the Code of Ethics and Conduct in this Article X.

MEDIA POLICY AND PROCEDURE

Background: Deceased patients are entitled to the same respect for the confidentiality of their personal information after death as they were in life. NAME Members have a responsibility to protect patient information, including investigative notes and medical records, in accordance with Federal, State, and jurisdictional laws when discussing case material.

NAME Members, when speaking to the media, are reminded their opinions do not represent the opinions of NAME. If a member is approached by the media to provide a statement on behalf of NAME, the member should decline request, obtain the name, and contact information of the reporter and immediately notify NAME's Executive Director for further guidance.

Meetings: The media/press can register and attend our annual and interim meetings. Media will be required to wear badges stating their name and affiliation. Their badges will have a yellow bar across the top of the badge which state "Media".

Absolutely NO photography, videography or audio recordings will be permitted unless otherwise authorized by a presenting author [i.e., QR codes]. Anyone in violation will be instructed to leave the meeting.

Member responsibility:

1. Each NAME member should be aware that media may attend our meetings and members need to understand that any comments made during the meeting should be considered "on the record" and do not represent the opinions of NAME.
2. Media will also be reminded that comments made by NAME members do not represent the opinions of NAME.
3. NAME members should be mindful that names of presentations and abstracts are available to meeting attendees, including the press and may want to assure a respectful tone in topic names and abstract information.

At the start of each session at the annual and interim NAME meetings, the moderator will remind members that media may be in attendance so any comments made during the Q and A session should be considered "on the record" and can be used by the media.

References: 3.1.5 Professionalism in Relationships with Media. CEJA Report 3-A-16 Modernized Code of Medical Ethics and AMA Principles of Medical Ethics: IV

LOUISVILLE MARRIOTT DOWNTOWN

Total Meeting Space **54,764 Sq. Ft.**

Ground Level

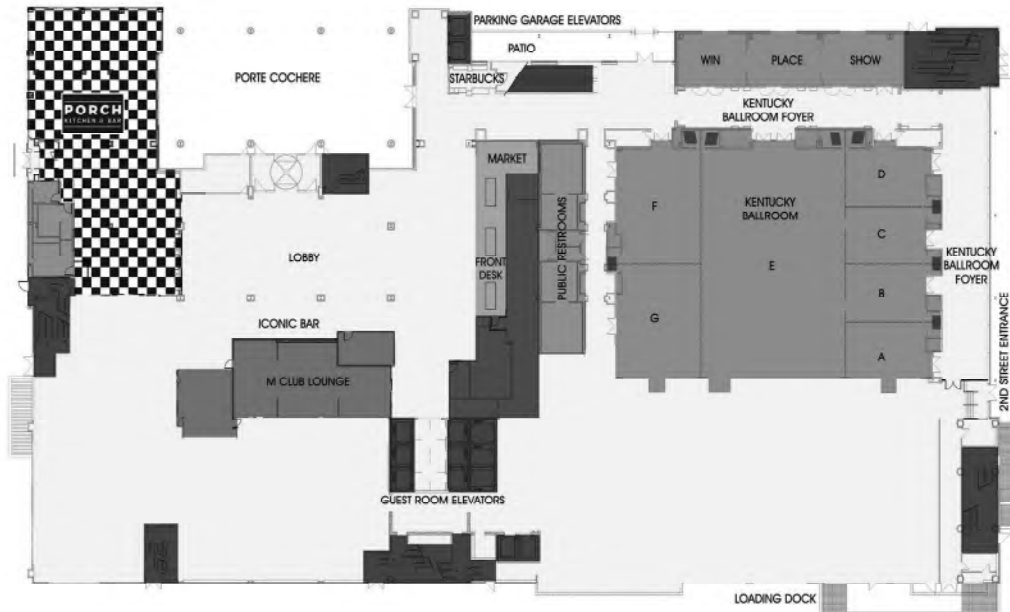

ROOM	SQ. FT.
Kentucky Ballroom Foyer (Pre Function)	4,263
Kentucky Ballroom	9,984
A	636
B	636
C	636
D	636
E	4,640
F	1,374
G	1,426
Win	500
Place	530
Show	577
TOTAL	15,854

Second Level



ROOM	SQ. FT.
Marriott Ballroom Foyer (Pre Function)	11,065
Marriott Ballroom	18,680
I - IV (each)	971
V - VI (each)	5,300
VII - X (each)	1,049
Clubhouse	637
Grand Stand	640
Paddock	641
Tack Room	290
Jockey Club	520
Skybox	850
Filly	656
Thoroughbred	670
Rose	1,023
Bluegrass 1	945
Bluegrass 2	945
Event Hub	1,008
Gate 1 - 3 (each)	336
Lily	88
Old Fashion	252
TOTAL	38,910

Welcome to the NAME 2025 Meeting!

Dear Colleagues and Friends,

Welcome to the National Association of Medical Examiners 2025 Annual Meeting. The NAME Annual Meeting provides an international forum for discussion of a broad range of issues pertaining to forensic pathology and death investigation. This year we have much to discuss and a wonderful host city to enjoy.

Meeting Highlights

The 2025 Annual Meeting will be held from Friday, October 17, through Tuesday, October 21, 2025, at the Louisville Marriott Downtown in Louisville, Kentucky.

The NAME Business Meeting will be held at the Marriott on Monday morning (October 20) at 8:00am before the scientific sessions begin for the day. The business meeting will include discussion of matters of interest to all NAME members; we urge you to attend so that you may contribute your voice and vote to the decisions made by NAME.

The advance program and other information are available on NAME's website <https://www.thename.org/name2025>.

Special Events

On Friday evening (October 17) the social activities will begin. We will kick off the meeting with our annual welcome reception and dinner at the Marriott followed by The Louis Jares Celebration of Life Dance Party.

Saturday (October 18) will begin with an optional Navigating Governmental Affairs and Advocacy Breakfast Briefing. NAME Foundation Thomas Noguchi, MD Lecture: "Coroner to the Stars" will be Saturday night.

The 27th Annual Rigor Run/Dead Man's Walk will take place early Sunday (October 19) in the morning. The 30th Annual Randy Hanzlick Memorial Cadaver Open Golf Tournament will be Sunday (October 19) following the morning scientific sessions.

Monday (October 20) will begin with Learn to Lead During Evolving Times from Forensic Pathology Leaders. The Voices: Amplify, Elevate, Celebrate Luncheon will also take place on Monday (October 20) featuring a panel of NAME members across career stages and practice settings discussing timely topics related to obstacles faced in practice and workforce development related to identities.

Tuesday (October 21) will begin with an optional Business of Forensic Pathology Breakfast. The NAME Luncheon and Awards Ceremony will take place at the hotel on Tuesday (October 21).

Special Acknowledgements

We gratefully acknowledge all who have provided input and effort into the planning and implementation of the meeting, especially the Members and Chair of the Education, Program and Publications Subcommittee. Thank you to our speakers for their contributions to the program and to our colleagues who have volunteered to moderate sessions. We would not be here without the dedication and expertise of our Executive Director, Denise McNally, and our Meetings Manager and Assistant Executive Director, Tara Snethen. Please take a moment to thank them personally when you see them — their tireless efforts made this gathering possible. Finally, the leadership and members of NAME acknowledge the gracious support of vendors and sponsors, without whom the meeting would be impossible.

We hope that the scientific program organized by the Program Committee will meet your highest expectations. The leadership of NAME asks all members to consider participating in one of our many committees in order to guarantee future successful meetings and the overall success of NAME. Also, please complete the online survey that will be sent to all participants at the end of the meeting. The program committee carefully considers this feedback to improve future meetings.

We welcome both our established and new colleagues and look forward to your active participation, which is essential to the success of this meeting. We hope that our new colleagues will consider joining NAME to take advantage of the year-round interactions that our current members enjoy.

Paul S. Uribe, MD, 2025 Program Chair
Reade A. Quinton, MD, 2025 President

NAME 59th Annual Meeting
Louisville Marriott Downtown – Louisville, Kentucky
October 17 – 21, 2025

NOTES

NAME 2025 Officers and Board of Directors

***President**

READE A. QUINTON, M.D.
Rochester, MN

KENT E. HARSHBARGER, M.D., J.D. (2026)
Dayton, OH

***Vice-President**

MICHELLE A. JORDEN, M.D.
San Jose, CA

HEATHER S. JARRELL, M.D. (2027)
Albuquerque, NM

***Secretary-Treasurer**

J. SCOTT DENTON, M.D.
Bloomington, IL

KELLY KEYES, ABMDI (2025)
Yorba Linda, CA

FENG LI, M.D., J.D. (2026)
Nashville, TN

BOARD OF DIRECTORS

***Chair of the Board**

J. KEITH PINCKARD, M.D., PH.D.
Austin, TX

***KATHERINE MALONEY, M.D. (2025)**
Buffalo, NY

EDWARD MAZUCHOWSKI, M.D., Ph.D. (2025)
Allentown, PA

DANIEL S. ATHERTON, M.D. (2026)
Birmingham, AL

BRANDI MCCLESKEY, M.D. (2025)
Birmingham, AL

***THEODORE T. BROWN, M.D. (2026)**
Little Rock, AR

CATHERINE MILLER, M.D. (2025)
West Palm Beach, FL

KRISTINE CAVICCHI, MPA (2027)
Boston, MA

BRYAN PLATT, MD (2025)
Dover AFB, DE

KIM COLLINS, M.D. (Ex-Officio)
Wadmalaw Island, SC

LORI PROE, D.O. (2025)
Albuquerque, NM

FRANCISCO DIAZ, M.D. (2026)
Washington, DC

CANDACE H. SCHOPPE, M.D. (2027)
Grapevine, TX

JONATHAN EISENSTAT, M.D. (2025)
Decatur, GA

GREGORY A. VINCENT, M.D. (2026)
Farmington, CT

KRISTINZA GIESE, M.D. (2025)
Washington, DC

BARBARA C. WOLF, M.D. (2026)
Leesburg, FL

***JAN GORNIK, DO (2027)**
Tallahassee, FL

TASHA L. ZEMRUS, M.D. (2025)
Fort Worth, TX

AMY GRUSZECKI, D.O. (2026)
Mesquite, TX

*Indicates Member of Executive Committee

M.J. MENENDEZ, J.D.
NAME EXECUTIVE VICE PRESIDENT
Doylestown, PA

DENISE MCNALLY
NAME EXECUTIVE DIRECTOR
Savannah, MO

TARA SNETHEN, CMP
NAME MEETINGS MANAGER/ASSISTANT EXECUTIVE DIRECTOR

NAME 59th Annual Meeting
Louisville Marriott Downtown – Louisville, Kentucky
October 17 – 21, 2025

NOTES

NAME 59th Annual Meeting
Louisville Marriott Downtown – Louisville, Kentucky
October 17 – 21, 2025

NAME 2025 Committees

Executive Committee

Theodore Brown, MD
J. Scott Denton, MD, *Secretary-Treasurer*
Jan Gorniak, DO
Michelle Jorden, MD, *Vice-President*
Katherine Maloney, MD
J. Keith Pinckard, MD, PhD, *Chair of Board*
Reade Quinton, MD, *President*

Board of Directors

Daniel Atherton, MD
*Theodore Brown, MD
Kristine Cavicchi, MS, MPA
Kim Collins, MD (*Ex-Officio*)
*J. Scott Denton, MD, *Secretary-Treasurer*
Francisco Diaz, MD
Jonathan Eisenstat, MD
Kristinza Giese, MD
*Jan Gorniak, DO
Amy Gruszecki, DO
Kent Harshbarger, MD, JD
Heather Jarrell, MD
*Michelle Jorden, MD, *Vice-President*
Kelly Keyes, Retired D-ABMDI
Feng Li, MD, JD
*Katherine Maloney, MD
Edward Mazuchowski, MD, PhD
Brandi McCleskey, MD
Catherine Miller, MD
*J. Keith Pinckard, MD, PhD, *Chair of Board*
Bryan Platt, MD
Lori Proe, DO
*Reade Quinton, M.D. *President*
Candace Schoppe, MD
Gregory Vincent, MD
Barbara Wolf, MD
Tasha Zemrus, MD
*Denotes Executive Committee

Ad hoc-Aeronautics and Space

Bamidele Adeagbo, MD
Sarah Avedschmidt, MD
Jason Byrd, PhD
Alexxys Clow, MHS
Mark Desantis, DO, MS
Jennifer E. Dierksen, MD
Bethany Faust, MD
Daniel Gallego, MD
Maggi L. Horn, MD
Heather Jarrell, MD
Jonathan Lucas, MD
Edward Mazuchowski, MD, PhD, *Chair*
Judy Melinek, MD
Monica Miyakawa-Liu, MD
Matthew Orde, MBChB
Maneesha Pandey, MD
Kathryn Pinneri, MD
Megan Quinn, MD
Andrew Rohrer, DO, MPH

Maria E. Smith, MD
Joshua Stephany, MD
Paul Uribe, MD
Gregory Vincent, MD
Adrienne Workman, MD

Ad hoc-Data

Sara Achrafi, MD
Sarah A. Anderson, DO
Valerie Arangelovich, MD
Zuhha Ashraf, MD
Katherine Bellas, DO
Thomas Blomquist, MD, PhD
Daniel Dye, MD, *Chair*
Michelle Elieff, MD
Bethany Faust, MD
Mark Giffen, DO
Abigail J. Grande, MPH
Thomas Herb, MD
Katelyn Moss, DO
Zachary O'Neill, DO
Kathryn Pinneri, MD
Mary Ann Sens, MD, PhD
Louis Smit, BA
Lo Tamburro, MD
Donald Turbiville, MD
Catherine Unger, MPA, MSW

Ad hoc-Forensic Toxicology

Charles Catanese, MD, *Co-Chair*
Lauren Decker, MD
Gregory Dickinson, MD
Jonathan Eisenstat, MD
Miriam Fisher, MD
Amanda Fisher-Hubbard
Fintan Garavan, MD, PhD
Daniel Isenschmid, PhD
George Jackson, PhD
Deborah Johnson, MD
Laura Labay, PhD, *Chair*
Katherine Maloney, MD
Sara Schreiber, PhD
Jennifer Swatek, MS
Donald Turbiville, MD
Jeff Walterscheid, PhD
Deland Weyrauch, MD

Ad hoc-Future Forensic Pathologist

Sarah Alexis Anderson, DO
Jenna Aungst, *Co-Chair*
Nicole Centazzo, MD
Mackenzie Cullip, BHSc
Jacob Darley, DO
Davina Dobbins, MBA, MPH
Tyler Dzuba, MS
Helen Ellsworth, MD
Kaylee Fox, DO
Mark Giffen, DO
Maggi Horn, MD
Nicolas Kosteletzky, MD
Brandi McCleskey, MD, *Chair*
Devon McCoy
Elizabeth Mcleod, MD

Cameron Negron, BS
Justine Newman
Zoie Nieto, MD
Matthew Pavelka, BS
Victoria Prager
Francisco Reyes Albaladejo
Wesley Roberts, MBA
Casey Schukow, DO
Lo Tamburro, MD
LaShay Taylor
Christina Vu, BS
Gilberto Vento, MD
Alayna Westcom, MD
Brittany Wilson, DO
Hannah Yerly

Ad hoc-Government Affairs

Natalia Belova, MD
Jacob Darley, DO
Francisco Diaz, MD
Eleanor Dyer, MD
Sean Hurst, MD
Lauren Lippincott, DO
James Luke, MD
Tara Mahar, MD
Vera Lucia Mendes-Kramer, PhD
Philip Miller, BS, F-ABMDI
Ellen Moffatt, MD
Jesse Mostoller, DO
Bryan Platt, MD
Sean Ricciardo, MD
Candace Schoppe, MD
Louis Smit, BA
Daniel Sullivan, MD
Anna Tart, MD, *Chair*

Ad hoc-International Relations

Sarah Avedschmidt, MD
Clare Bryce, MD
Paul Chui, DMJ
Kim Collins, MD, *Chair*
Lorraine Du Toit-Prinsloo, MBChB
Oguzhan Ekizoglu, MD
Muhammad Ahmad Faraz, MBBS
Lorenzo Gitto, MD
Masahiko Kobayashi, MD, PhD
Hae-Sun La, MD
Wijesingh Lakmali, MBBS
Feng Li, JD, MD
Dianne Little, MBBS
Thomas Noguchi, MD, *Emeritus Chair*
Pierre Antoine Peyron, MD
Sean Ricciardo, MD
Murari Sarangi, MBBS
Ilaria Tarozzi
Barbara Wolf, MD

Ad hoc-Legal Affairs

Jonathan Briskin, JD, MD
Beth Devery, RN, JD
Eleanor Dyer, MD
Juniper Fedor, MS, PA(ASCP)CM
Feng Li, JD, MD

NAME 59th Annual Meeting
Louisville Marriott Downtown – Louisville, Kentucky
October 17 – 21, 2025

MJ Menendez, JD
Victor Weedn, JD, MD, *Chair*

Ad hoc- Manner of Death Guide

Ponni Arunkumar, MD
Kristinza Giese, MD
James Gill, MD
Jeffrey Johnston, MD
Laura Knight, MD
Katherine Maloney, MD
J. Kieth Pinckard, MD, PhD
Kathryn Pinneri, MD, *Chair*
Reade Quinton, MD
Hayley Thompson, *Consultant*
Sara Tuuk, MS, *Consultant*

Ad hoc- Mass Fatality Incidents

Sanisha Bailey, MS
Thomas Blomquist, MD, PhD
Jason Byrd, PhD
Carlo Campobasso, MD, PhD
Don Cavadini
Harshani Dandeniya Arachchi, MD
Jacob Darley, DO
Mark Desantis, DO
Gregory Dickinson, MD
Oguzhan Ekizoglu, MD
Bryan Hoffmann, BA
Sean Hurst, MD
Sherry Jilinski, MD
Kelly Kruse, MD
Sarah Maines, MD
Katherine Maloney, MD, *Chair*
Daniel Nguyen, MD
Paul Petrino, MA
Bryan Platt, MD
Louis Smit, BA
Meryle St Louis, MA
Selly Strauch, MD
Thomas Van De Berg, MFS
Rosa Vega, MS
Tabitha Ward, MD
David Waters, MD
Erika Wheeler, MD

Ad hoc-Medicolegal Death Investigation

Cecilia Arguelles
Ponni Arunkumar, MD, *Chair*
Laura Bailey
Sanisha Bailey, MS
Robert Byrd, PhD
Carri Cottengim, MA
Brian Ehret, F-ABMDI
Jan Gorniak, DO
Tom Hensley, F-ABMDI
Michelle Jorden, MD
Bridget Kinnier, BS
Kristen Long
Philip Miller, BS, F-ABMDI
Kelli Oxborrow, BS
Richard Riffle, BS
Agnieszka Rogalska, MD
Ralph Saccone, BS
Vanessa Schmidt

Bethany Smith, MPA
Lauren Thoma, MD
Jackie Ulven, BS
Rosa Vega, MS

Ad hoc-Organ and Tissue Donation

Amanda Abbott
Jeremy Benavides, BS
Jonathan Boyd, MS
Anthony Cannata, BA
Don Cavadini
Kim Collins, MD
Hannah Coltrain, MS
Mackenzie Cullip, BHSc
Tony Cusinato
Sharon Derrick, PhD
Janice Diaz, MD
Chris Donhost
Gerald Gowitt, MD
Hannah Jarvis, MBBS
Daniel Kepler, BS
Debra Lanter, BS
Ling Li, MD
Catherine Miller, MD, *Chair*
Maneesha Pandey, MD
J. Keith Pinckard, MD, PhD
Gregory Schmunk, MD
Julie Schrader, DO
Stacy Thomas, MD, PhD
Yen Van Vo, MD
Joshua Voyles, MA
Amanda Youmans, DO

Ad hoc-Postmortem Imaging

Natalie Adolphi, PhD, MS
Danielle Armstrong, DO
Anthony Cannata, BA
Paul Chui, DMJ
Karen Cline-Parhamovich, DO
Mackenzie Cullip, BHSc
Janice Diaz, MD
Lauren Edelman, MD, *Chair*
Jonathan Eisenstat, MD
Howard Harcke, MD
Heather Jarrell, MD
Evan Matshes, MD
Edward Mazuchowski, MD, PhD
Owen Middleton, MD
Daniel Nguyen, MD
Alex Penev, MD, PhD
Catherine Perez, MD
Amy Rapkiewicz, MD
Julie Schrader, DO
Lindsay Taute, MD
Natalie Taylor, MD
Shaku Teas, MD
Amy Tharp-Myers, MD
Stacy Thomas, MD, PhD
David Waters, MD
Erika Wheeler, MD
Nicole Yarid, MD

Ad hoc-Public Health

Sara Achrati, MD
John Agboola, MBBS

Joshua Akers, MD, *Chair*
Sarah Anderson, DO
Ponni Arunkumar, MD
Katherine Bellas, DO
Erin Brooks, MD
Martha Burt, MD
Yonatan Carl, MD
Irfan Chaudhry, MD
Carri Cottengim, MA
Nicole Croom, MD
Emily Dennison, MD
Sarah Edminster, DO
Thomas Gilson, MD
Abigail Grande, MPH, *Co-Chair*
Bryan Hoffman, BA
Sherry Jilinski, MD
Anna Vi Jones, MD
Kelly Kruse, MD
Sarah Maines, MD
Ellen Moffatt, MD
Melissa Pasquale-Styles, MD
Kimberly Repp, PhD, MPH
Cameron Semore, MD
Michael Staley, PhD
Catherine Unger, MPA, MSW
Samantha Wetzler, MD
Ziemin Zhou, MD

Ad hoc-Social Media

Jenna Aungst, OMS-II
Casem Ballouk, MD
Joy Edegbe, MD
Muhammad Ahmad Faraz, MBBS
Nicole Fye, BS
Erik Handberg, MD
Patrick Hansma, DO, *Chair*
Nicole Jackson, MD, MPH
Wijesinghe Lakmali, MBBS
Sarah Joy Lewis, DO
Amber Melchers, MHS, PA(ASCP)CM
Judy Melinek
Ross Miller, MD
Paul Uribe, MD
Alayna Westcom, MD

Ad hoc-Visa Applicant Advisory Committee

Anfisa Baiandurova, MD
Clare Bryce, MD, *Chair*
Kim Collins, MD
Lorenzo Gitto, MD, *Co-Chair*
Masahiko Kobayashi, MD, PhD
Anita Lal, MD
Mario Rascon, MD
Jesus Rico-Castillo
Julian Samuel, MBBS
Ilaria Tarozzi, MD

Ad hoc-Website

Ronni Arden, BS
Ponni Arunkumar, MD
Jenna Aungst, OMS-II
Casem Ballouk, MD
Dean Beers
Kristine Cavicchi, MS, MPA

NAME 59th Annual Meeting
Louisville Marriott Downtown – Louisville, Kentucky
October 17 – 21, 2025

J. Scott Denton, MD
Janice Diaz, MD
Natasha Grandhi, MD
Emma Henrie, MD
Nicolas Kosteletzky, MD
Wijesinghe Lakmali, MBBS
Reade Quinton, MD, *Chair*
Carl Stacy, MD
Jay Stahl-Herz, MD
Lo Tamburro, MD
Gregory Vincent, MD
John Walsh, MD

Ad hoc-Workplace Stress and Wellness

Denika Adams, DO
Sarah Anderson, DO
Valerie Arangelovich, MD
Joy Edegbe, MD
Amanda Fisher-Hubbard, MD
Heather Jarrell, MD, *Chair*
Anna Vi Jones, MD
Kelly Keyes, Retired D-ABMDI
Laura Knight, MD, *Co-Chair*
Brandi McCleskey, MD
Elizabeth McLeod, MD
Jesse Mostoller, DO
Kelli Oxborrow, BS
Mary Pietrangelo, MD
John-Luke Rivera, MD
Jessica Schmitt, MD
Christina Schock, MA
Leticia Schuman, MD
Tuyet Hong Tran, DO
Merisah Trisciuzzi, MA
Amanda Youmans, DO

Awards

Michelle Aurelius, MD
Adam Covach, MD
Joyce deJong, DO, *Chair*
Edmund Donoghue, MD
Kristinza Giese, MD
Lorenzo Gitto, MD
Jan Gorniak, DO
Kimberly Johnson, MD
Marcus Nashelsky, MD
Zachary O'Neill, DO
Sajid Qaiser, MD
Jay Stahl-Herz, MD
Barbara Wolf, MD

Bylaws

Kristine Cavicchi, MS, MPA
Joyce deJong, DO
Francisco Diaz, MD
Edmund Donoghue, MD, *Chair*
Jonathan Eisenstat, MD
Marcella Fierro, MD
Lorraine Lopez-Morell, MD
Deanna Oleske, MD
Lorraine Roth-Moyo, MD
Lakshmanan Sathyavagiswaran, MD
Tasha Zemrus, MD

Education, Program and Publications

Sally Aiken, MD, *Ex-Officio*
Nicholas Batalis, MD, *Ex-Officio*
Maura DeJoseph, DO, *Ex-Officio*
Alison Krywanczyk, MD, *Ex-Officio*
Brian Peterson, MD, *Ex-Officio*
Fabiola Righi, DO, *Ex-Officio*
Robert Stoppacher, MD, *Chair*
Timothy Williams, MD, *Ex-Officio*

EPP-Continuing Certification (CC)

Nicholas Batalis, MD, *Chair*
Michelle Elieff, MD
Christine James, DO
Michael Johnson, MD, PhD
Martina Kennedy, DO
Angelina Phillips, MD
Susan Presnell, MD
Virginia Richards, MD
Juliette Scantlebury, MD
Selly Strauch, MD
Alex Williamson, MD

EPP-Educational Activities (EAC)

Hind Abouzahir, MD, PhD
Daniel Atherton, MD
Thomas Auen, DO
Samantha Engrav, BA
Nicole Fye, BS
Lorenzo Gitto, MD, *Co-Chair*
Neil Haycocks, MD, PhD
Amanda Hersh, DO
Kimberly Johnson, MD
Laura Labay, PhD
Lauren Lippincott, DO
Hannah McQueen, MD
Sajid Qaiser, MD
Fabiola Righi, DO, *Chair*
Vivian Snyder, DO
Nadia Solomon, MD
Amy Tharp-Myers, MD
Karin Wells, MA
Alayna Westcom, MD
Rebecca Wyma, MD

EPP-Education / Program

Nika Aljinovic, MD
Zuhha Ashraf, MD
Michelle Aurelius, MD
Bridget Eutenier, MD
Natasha Grandhi, MD
Emma Henrie, MD
Amanda Hersh, DO
Lauren Huddle, MD
Nicole Jackson, MD, MPH
Kimberly Johnson, MD
Kacy Krehbiel, MD
Lorraine Lopez-Morell, MD
Ashley Lukefahr, MD
Brian Peterson, MD, *Chair*
J. Keith Pinckard, MD, PhD, *Ex-officio*
Lori Proe, DO
Michele Stauffenberg, MD
Robert Stoppacher, MD, *Ex-officio*

Paul Uribe, MD
Joshua Voyles, MA

EPP-Forensic Fellow In-Service Exam (FISE)

Joshua Akers, MD
Nika Aljinovic, MD
Marianne Beynon, MD
Erin Brooks, MD
Daniel Butler, MD
Lauren Decker, MD
Michelle Elieff, MD
Amanda Fisher-Hubbard, MD
Lorenzo Gitto, MD
Stefanie Grewe, MD
Dawn Holmes, MD
Marisa Jacob-Leonce, MD
Christine James, DO
Michelle Jorden, MD
Ashley Lukefahr, MD
David Lynch, MD
Katherine Maloney, MD
Angelina Phillips, MD
Lori Proe, DO
Brandy Shattuck, MD
Timothy Williams, MD, *Chair*

EPP-Forensic Pathology Fellowship Training

Maura DeJoseph, DO, *Chair*
Stephanie Dean, MD
Daniel Dye, MD
Lauren Edelman, MD
Erin Ely, MD
Susan Ely, MD
Joseph Felo, DO
Meredith Frank, MD
Kristinza Giese, MD
Dana Hopson, MD
Christine James, DO
Peter Lin, MD
Lorraine Lopez-Morell, MD
Brandi McCleskey, MD
Jerri McLemore, MD
Angelina Phillips, MD
J. Keith Pinckard, MD, PhD
Kanayo Tatsumi, MD
Jason Van Roo, MD
Tabitha Ward, MD
Rebecca Wilcoxon, MD

EPP-Journal

Hind Abouzahir, MD, PhD
Rebeca Asch-Kendrick, MD
Martha Burt, MD
Daniel Butler, MD
Jennifer Dierksen, MD
Oguzhan Ekizoglu, MD
Susan Ely, MD
Neil Haycocks, MD, PhD
Alison Krywanczyk, MD, *Chair*
Andrew Layman, MD
Ling Li, MD
Francesco Lupariello, MD
Owen Middleton, MD

D. Kimberley Molina, MD, *Ex-Officio*
Susan Presnell, MD
Murari Sarangi, MBBS
Donald Turbiville, MD

EPP-Position Papers

Sally Aiken, MD, *Chair*
Nika Aljinovic, MD
Daniel Atherton, MD
Erin Brooks, MD
Karen Cline-Parhamovich, DO
Maura DeJoseph, DO
Lauren Edelman, MD
Monica Goodnough, BS
Heather Jarrell, MD
P. Douglas Kelley, MD
Alison Krywanczyk, MD
Evie Li
Tara Mahar, MD
Erica Price, MS
Jose Ruiz Arango, MD
Carl Schmidt, MD
Joshua Voyles, MA
Alex Williamson, MD
Tasha Zemrus, MD

EPP-POSITION PAPERS in Progress

Advanced Imaging Techniques in Forensic Pathology

Natalie Adolphi, PhD, MS
Karen Cline-Parhamovich, DO
Lauren Edelman, MD, *Chair*
Howard Harcke, MD
Heather Jarrell, MD
Edward Mazuchowski, MD, PhD
Lindsay Taute, MD

Investigation and Certification of Fetal Demise, Stillborn, and Early Neonatal Deaths

James Gill, MD
Nicole Jackson, MD, MPH
Olga Joos DrPH, MOH, RN
Alison Krywanczyk, MD, *Chair*
Kristen Landi, MD
Katherine Maloney, MD
Chris Milroy, MBChB, MD
Maneesha Pandey, MD
Stacey Reed, MD
Robert M. Silver, MD
Kaitlin Weaver, DO

Legislative Encroachment on the Practice of Forensic Pathology

Sally Aiken, MD
Daniel Atherton, MD
Theodore Brown, MD
Jeffrey Johnston, MD
Michelle Jorden, MD
Katherine Maloney, MD
Brandi McCleskey, MD
MJ Menendez, JD, *Chair*
Keith Pinckard, MD, PhD
Reade Quinton, MD

Recommendations for the Investigation, Diagnosis, and Certification of Heat and Cold-Related Deaths

Nika Aljinovic, MD
Erin Brooks, MD, *Chair*
J. Scott Denton, MD
Maura DeJoseph, DO
Lauren Edelman, MD
Edmund Donoghue, MD
Michael Graham, MD
Jeffrey Johnston, MD
Michelle Jorden, MD
P. Douglas Kelley, MD
Tara Mahar, MD

Recommendations for the Postmortem Assessment of Suspected Head Trauma in Infant and Young Children

Elizabeth Bundock, MD
Kristinza Giese, MD
James Gill, MD, *Chair*
Cynthia Harris, *Consultant*
Heather Jarrell, MD
Michelle Jorden, MD
Jennifer Love, *Consultant*
Tara Mahar, MD
Evan Matshes, MD
Deanna Oleske, MD
Gregory Vincent, MD

Postmortem Genetic Testing in Forensic Pathology Cases

Lisa Marie Castillo, MS, *Consultant*
Joyce deJong, DO
Alison Krywanczyk, MD, *Chair*
Lisa Ann Gavin, MD
Kara Gawelek, MD
Ellen Hostetler, *Consultant*
Basma Klump, *Consultant*
Laura Knight, MD
Heather MacLeod, MS, *Co-Chair*
Elizabeth M. McNally, MD, PhD, *Consultant*
Kathryn Pinneri, MD
Yingying Tang, MD, *Consultant*
R. Gregory Webster, MD, MPH, *Consultant*

Recommendations for the Investigation of Maternal Deaths

Corinne Fligner, MD
Maura DeJoseph, DO
Jan Gorniak, DO
Marianne Hamel, MD, PhD, *Consultant*
Karen Kelly, MD
Miranda Klassen, *Consultant*
Tara Mahar, MD
Katherine Maloney, MD, *Chair*
Torri Metz, MD, *Consultant*
Melissa Pasquale-Styles, MD

EPP-Scientific Presentations Awards

Russell Alexander, MD
Nicholas Batalis, MD
Daniel Butler, MD
Jan Gorniak, DO
Avneesh Gupta, MBBS
Altaf Hossain, MD, PhD
Lauren Huddle, MD
Kimberly Johnson, MD
Jamie Kallan, MD
Amanda Maskovyak, MD
Ashley Mathew, MD
Diane Peterson, MD
J. Keith Pinckard, MD, PhD
Reade Quinton, MD
Robert Stoppacher, MD, *Chair*
Mark Super, MD
Yen Van Vo, MD

Ethics Committee

Jared Brooks, MD
Adam Covach, MD
Kent Harshbarger, JD, MD, *Chair*
Altaf Hossain, MD, PhD
Karen Kelly, MD
J. Matthew Lacy, MD
Ashley Mathew, MD
Hilary McElligott, MD
Catherine Miller, MD
Frank Miller, MD
Lorraine Roth-Moyo, MD
Leticia Schuman, MD
Stacey Simons, MD
Mark Super, MD
Jason Van Roo, MD
Samantha Wetzler, MD
Jiemin Zhou, MD

Finance Committee

Kristine Cavicchi, MS, MPA (2025)
Francisco Diaz, MD (2027)
J. Scott Denton, MD, *Ex-Officio*
Brian Peterson, MD, *Chair* (2026)
Deanna Oleske, MD (2028)

Inclusion, Diversity, and Equity Action (IDEA)

Bamidele Adeagbo, MD
Rebecca Asch-Kendrick, MD
Thomas Auen, DO
Sanisha Bailey, MS
Mira Basuino, BS
Robert Byrd, DDS
Hannah Coltrain, MS
Emily Dennison, MD
Samantha Engrav, BA
Juniper Fedor, MS, PA(ASCP)CM
Kristinza Giese, MD
Jan Gorniak, DO, *Chair*
Nicole Jackson, MD, MPH
Marisa Jacob-Leonce, MD
Nicole Johnson, DO
Prentiss Jones, Jr, PhD
Karen Kelly, MD

NAME 59th Annual Meeting
Louisville Marriott Downtown – Louisville, Kentucky
October 17 – 21, 2025

Alison Krywanczyk, MD
Debra Lanter, BS
Kelly Lear, MD
Nikolas Lemos, PhD
Sarah Joy Lewis, DO
Rachel Martindale, PA
Andrew Mazurek, MBBCh
Amber Melchers, MHS, PA(ASCP)CM
Monica Miyakawa-Liu, MD
Catherine Perez, MD
John-Luke Rivera, MD
Julian Samuel, MBBS
Carl Stacy, MD
William Stano, MD
Rameen Starling-Roney, MD
Daniel Sullivan, MD
Lo Tamburro, MD
Kanayo Tatsumi, MD

Inspection and Accreditation

Ponni Arunkumar, MD
Lindsey Bayer, F-ABMDI
Alexander Blank, MD
Irfan Chaudhry, MD
Paul Chui, DMJ
Steven Clark, PhD, *Consultant*
Tracey Corey, MD
Nicole Croom, MD, MPH
Constance DiAngelo, MD
Ljubisa Dragovic, MD
Daniel Dye, MD
Daniel Gallego, MD
David Garavan, MD, PhD
Lorenzo Gitto, MD
Amy Gruszecki, DO
Brett Harding, BA, MBA
Dean Havlik, MD
Emma Henrie, MD
Karen Kelly, MD
Chin Thye Lee, MBChB
Edward Mazuchowski, MD, PhD
D. Kimberley Molina, MD
Marcus Nashelsky, MD
George Paul, MD
Brian Peterson, MD, *Co-Chair*
Kathryn Pinneri, MD
Juliette Scantlebury
Gregory Schmunk, MD
Sara Schreiber, PhD
Mary Ann Sens, MD, PhD
Kyle Shaw, MBBS
Shane Sheets, MBA
Jay Stahl-Herz, MD
Rameen Starling-Roney, MD
Lindsay Taute, MD
Shaku Teas, MD
Tuyet Hong Tran, DO
Paul Uribe, MD
Barbara Wolf, MD, *Chair*
Nicole Yarid, MD

**Inspection and Accreditation –
International Subcommittee**

Ponni Arunkumar, MD
Paul Chui, DMJ

D. Kimberley Molina, MD
George Paul, MD
Barbara Wolf, MD, *Chair*

**Inspection and Accreditation –
Certified Inspectors**

Joshua Akers, MD
Ponni Arunkumar, MD
Alexander Blank, MD
Cassie Boggs, MD
Ljubisa Dragovic, MD
Daniel Dye, MD
Lorenzo Gitto, MD
Jan Gorniak, DO
Amy Gruszecki, DO
Brett Harding, BA, MBA
Amy Hart, MD
Dean Havlik, MD
Emma Henrie, MD
Hannah Jarvis, MBBS
Karen Kelly, MD
Edward Mazuchowski, MD, PhD
Owen Middleton, MD
D. Kimberley Molina, MD
Marcus Nashelsky, MD
Maneesha Pandey, MD
Brian Peterson, MD, *Co-Chair*
Boguslaw Robert Pietak, MD
Carolyn Revercomb, MD
Carl J. Schmidt, MD
Gregory Schmunk, MD
Mary Ann Sens, MD, PhD
Kyle Shaw, MBBS
Jay Stahl-Herz, MD
Rameen Starling-Roney, MD
Lindsay Taute, MD
Shaku Teas, MD
Paul Uribe, MD
Victor Weedn, MD, JD
Barbara Wolf, MD, *Chair*

Membership and Credentials

Christopher Boden, BS
Jared Brooks, MD
Theodore Brown, MD, *Chair*
J. Scott Denton, MD, *Ex-Officio*
Stefanie Grewe, MD
Lauren Huddle, MD
Kelly Lear, MD
David Lynch, MD
Rachel Martindale, PA
Virginia Richards, MD
Lakshmanan Sathyavagiswaran, MD
Thomas Van De Berg, MFS

**NAME Foundation Board of
Trustees**

Theodore Brown, MD
John Butts, MD
Kim Collins, MD, *Chair*
Joseph Felo, DO
Jan Gorniak, DO
Heather Jarrell, MD
Michelle Jorden, MD, *Ex-Officio*
Edward Mazuchowski, MD, PhD

Denise McNally, *Ex-Officio*
Frank Miller, MD
Christopher Milroy, MD
Thomas Noguchi, MD, *Founding
Director*
Maneesha Pandey, MD
Brian Peterson, MD
J. Keith Pinckard, MD, PhD, *Ex-Officio*
Reade Quinton, MD, *Ex-Officio*
Michael Rieders, PhD
Gregory Schmunk, MD, *Secretary-
Treasurer*
Mark Super, MD
Samantha Wetzler, MD

Nominating Committee

Francisco Diaz, MD
James Gill, MD
Kent Harshbarger, MD
Frank Miller, MD, *Chair*
Kathy Pinneri, MD

Past Presidents

Sally Aiken, MD
Andrew Baker, MD
Michael Bell, MD
John Butt, MD
Kim Collins, MD
Gregory G. Davis, MD
Joyce deJong, DO
Edmund Donoghue, MD
Marcella Fierro, MD
Dave Fowler, MD
Jerry Francisco, MD
James Gill, MD
Michael Graham, MD
Elliot Gross, MD
Ali Hameli, MD
John Howard, MD
John Hunsaker, JD, MD
Jeffrey Jentzen, MD
Marcus Nashelsky, MD
Thomas Noguchi, MD
Brian Peterson, MD
Garry Peterson, JD, MD
J. Keith Pinckard, M.D., PhD
Kathryn Pinneri, MD
Joseph Prahlow, MD
Lakshmanan Sathyavagiswaran, MD,
Chair
Gregory Schmunk, MD
Mary Ann Sens, MD, PhD
Ross Zumwalt, MD

Standards

Ponni Arunkumar, MD
Erik Christensen, MD
Karen Cline-Parhamovich, DO
Joyce deJong, DO
Lauren Edelman, MD
Heather Jarrell, MD
Hannah Jarvis, MBBS
Michael Johnson, MD, PhD
Laura Knight, MD
Evan Matshes, MD

NAME 59th Annual Meeting
Louisville Marriott Downtown – Louisville, Kentucky
October 17 – 21, 2025

Edward Mazuchowski, MD, PhD
Jerri McLemore, MD
J. Keith Pinckard, MD, PhD, *Chair*
Lori Proe, DO
Lorraine Roth-Moyo, MD
Lakshmanan Sathyavagiswaran, MD
Kyle Shaw, MBBS
Vivian Snyder, DO
Jay Stahl-Herz, MD
Michele Stauffenberg, MD
Anna Tart, MD
Tasha Zemrus, MD

Strategic Planning

Ronni Arden, BS
Jenna Aungst, OMS-II
Theodore Brown, MD
Jacob Darley, DO
Erin Ely, MD
Briana Fernandez, MD
Prentiss Jones, Jr, PhD
Nicolas Kostecky, MD
Feng Li, JD, MD
Erin Linde, MD
Brandi McCleskey, MD
MJ Menendez, JD, *Chair*
Frank Miller, MD
Katelyn Moss, DO
J. Keith Pinckard, MD, PhD
Bryan Platt, MD
Kathryn Rice, MD
Michael Rieders, PhD
Dan Schebler
Carl Schmidt, MD
Candace Schoppe, MD
Mark Super, MD
Anna Tart, MD
John Walsh, MD
Victor Weedn, MD, JD, *Co-Chair*
Deland Weyrauch, MD
Brittany Wilson, DO

**Strategic Planning-Workforce
Development Subcommittee**

Ponni Arunkumar, MD
Jenna Aungst, OMS-II
Megan Carter
Adam Covach, MD
Jacob Darley, DO
Maura DeJoseph, DO
Constance DiAngelo, MD
Grace Dukes, MD
Erin Ely, MD
Mark Giffen, DO
Marie Hansen, MD
Emma Henrie, MD
Dana Hopson, MD
Altaf Hossain, MD, PhD
Nicole Johnson, DO
Jamie Kallan, MD
Laura Knight, MD
Nicolas Kostecky, MD
Erin Linde, MD
Brandi McCleskey, MD, *Co-Chair*
Elizabeth Mcleod, MD

MJ Menendez, JD, *Chair*
Monica Miyakawa-Liu, MD
Jesse Mostoller, DO
Erica Price, MD
Kathryn Rice, MD
Carl Schmidt, MD
Jessica Schmit, MD
Candace Schoppe, MD
Brandy Shattuck, MD
Lauren Thoma, MD
Paul Uribe, MD
Christina Vu, BS
John Walsh, MD
Karin Wells, MA
Deland Weyrauch, MD
Brittany Wilson, DO
Zobidah Yousif

Liaisons

**American Board of Forensic
Anthropology (ABFA)**

Wendy McQuade, PhD

**American Board of Pathology
(ABPath)**

Maura DeJoseph, DO

American Medical Association

Michelle Jorden, MD, *Delegate*
Ponni Arunkumar, MD, *Alternate Delegate*

**American Medical Association CPT
Advisory Committee**

J. Scott Denton, MD, *Delegate*

**American Medical Association RVS
Update Committee (RUC) Advisory
Committee**

Michelle Jorden, MD, *Delegate*
Ponni Arunkumar, MD, *Alternate Delegate*

**American Society for Clinical
Pathology (ASCP)**

Nicole Jackson, MD, MPH

**Association of Academic Pathology
- Liaison (Formerly Association for
Pathology Chairs-APC) Liaison**

Brandi McCleskey, MD

**College of American Pathologists
(CAP) Liaison**

Michelle Aurelius, MD

**Consortium of Forensic Sciences
Organizations (CFSO) Liaison**

James Gill, MD

**Forensic Sciences Standards Board
(FSSB) of OSAC**

Sally Aiken, MD

ICPI/IPC Liaison

Avneesh Gupta, MD

National Medical Association (NMA)

Kristinza Giese, MD

**Society for Cardiovascular
Pathology (SCVP)**

Alison Krywanczyk, MD

**United States and Canadian
Academy of Pathology (USCAP)**

Melissa Blessing, DO

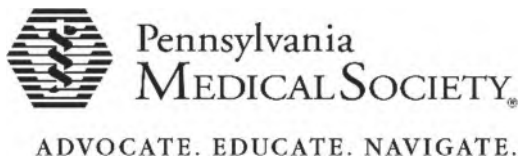

CME Accreditation Statement:

This activity has been planned and implemented in accordance with the accreditation requirements and policies of the Accreditation Council for Continuing Medical Education (ACCME) through the joint providership of the Pennsylvania Medical Society and National Association of Medical Examiners. The Pennsylvania Medical Society is accredited by the ACCME to provide continuing medical education for physicians.

AMA Designation Statement:

The Pennsylvania Medical Society designates this live activity for a maximum of *28.25 AMA PRA Category 1 Credit(s)*[™]. Physicians should claim only the credit commensurate with the extent of their participation in the activity.

NAME 59th Annual Meeting
Louisville Marriott Downtown – Louisville, Kentucky
October 17 – 21, 2025

NOTES

THURSDAY, OCTOBER 16, 2025

COMMITTEE MEETING [NOT CME]:

8:00 AM – 5:00 PM	Executive Committee Meeting (Invitation Only) <i>Clubhouse, Second Level</i>
5:30 PM – 8:30 PM	Executive Committee Dinner (Invitation Only)

FRIDAY, OCTOBER 17, 2025

GENERAL INFORMATION [NOT CME]:

10:00 AM – 5:00 PM	Pre-Registration (Exhibitors & Attendees) <i>Kentucky Ballroom Foyer, Ground Level</i>
1:00 PM – 4:00 PM	Installation of Exhibits <i>Kentucky Ballroom, Ground Level</i>
5:00 PM – 6:00 PM	International Attendee Reception <i>Rose, Second Level</i> <i>Sponsored by Kim A. Collins, MD and Michael F. Rieders, PhD</i>
6:00 PM – 8:00 PM	Grand Opening of Exhibits Welcome Reception and Dinner (Registrants and Ticket Holders Only) <i>Kentucky Ballroom, Ground Level</i>
8:00 PM – 10:00 PM	The Louis Jares Celebration of Life Dance Party <i>Marriott Ballroom Salon 1-5, Second Level</i>

COMMITTEE MEETINGS [NOT CME]:

7:00 AM – 8:00 AM	NAME Foundation Board of Trustees Meeting <i>Bluegrass I – II, Second Level</i>
8:00 AM – 12:00 PM	Board of Directors Meeting <i>Bluegrass I – II, Second Level</i>
12:30 PM – 4:30 PM	Strategic Planning Committee Meeting <i>Bluegrass I – II, Second Level</i>
2:00 PM – 3:00 PM	Inspection & Accreditation Committee Meeting <i>Rose, Second Level</i>
3:00 PM – 5:00 PM	Ad Hoc Organ and Tissue Donation Committee Meeting <i>Clubhouse, Second Level</i>
4:30 PM – 5:00 PM	NAME Foundation Business Meeting <i>Show, Ground Level</i>
4:30 PM – 5:00 PM	Educational Activities Committee Meeting <i>Win, Ground Level</i>

SATURDAY, OCTOBER 18, 2025

GENERAL INFORMATION:

6:45 AM – 8:00 AM	Buffet Breakfast (Registrants and Ticket Holders Only) [NOT CME] <i>Kentucky Ballroom, Ground Level</i>
7:00 AM – 5:00 PM	Registration [NOT CME] <i>Kentucky Ballroom Foyer, Ground Level</i>
7:00 AM – 8:00 AM	Navigating Governmental Affairs and Advocacy – Breakfast Briefing (Optional) [NOT CME] <i>*Additional Payment Required*</i> <i>Filly/Thoroughbred, Second Level</i>
8:00 AM – 3:45 PM	Exhibits [NOT CME] <i>Kentucky Ballroom, Ground Level</i>
8:00 AM – 5:00 PM	Posters <i>Kentucky Ballroom Foyer, Ground Level</i>
5:15 PM – 6:45 PM	Resident/Fellow Reception and Fellowship Fair (Invitation Only) [NOT CME] <i>Marriott Ballroom Salon 5, Second Level</i> <i>Sponsored by our Diamond Level Corporate Partner, NMS Labs</i>

NAME 59th Annual Meeting
Louisville Marriott Downtown – Louisville, Kentucky
October 17 – 21, 2025

8:00 PM – 10:00 PM NAME Foundation Thomas Noguchi, MD Lecture: “Coroner to the Stars”
Marriott Ballroom Salon 6-10, Second Level

COMMITTEE MEETINGS [NOT CME]:

7:00 AM – 8:00 AM Manner of Death Guide Committee Meeting
Clubhouse, Second Level
7:00 AM – 8:00 AM Forensic Toxicology Committee Meeting
Bluegrass I-II, Second Level
12:00 PM – 1:30 PM Past Presidents Committee Meeting and Lunch
Porch Kitchen & Bar, Ground Level

PROGRAM INFORMATION:

8:00 AM – 10:05 AM SESSION 1: WELCOME, INTRODUCTION, AND MASS CASUALTY
Moderators: Gail L. Parker, BS, DeKalb County Medical Examiners Office & Forensic Medicine Associates, Inc., Decatur, Georgia, United States of America and Jamie E. Kallan, MD, University of Wisconsin School of Medicine and Public Health, Madison, Wisconsin, United States of America
Marriott Ballroom Salon 6-10, Second Level

8:00 AM – 8:15 AM Welcome and Introduction [NOT CME]

8:15 AM – 8:45 AM 1.1 The Advancement of Forensic Pathology: A History
Patrick Hansma, DO, Western Michigan University Homer Stryker M.D. School of Medicine, Kalamazoo, Michigan, United States of America

8:45 AM – 9:30 AM 1.2 Mass Fatality Response in Practice: Experience, Challenges, and Lessons Learned from the District of Columbia Office of the Chief Medical Examiner
Francisco J. Diaz, MD, Washington DC Office of the Chief Medical Examiner, Washington, DC, United States of America, Micayla C. Spiros, PhD, Washington DC Office of the Chief Medical Examiner, Washington, DC, United States of America, Nahimarys Colon Hernandez, MD, Washington DC Office of the Chief Medical Examiner, Washington, DC, United States of America, Kristinza W. Giese, MD, Washington DC Office of the Chief Medical Examiner, Washington, DC, United States of America and Tatyana Zinger, DO, Washington DC Office of the Chief Medical Examiner, Washington, DC, United States of America

9:30 AM – 9:45 AM 1.3 Fatalities due to Hurricane Beryl in Texas
Hannah Claire Jarvis, MBBS, Harris County Institute of Forensic Sciences, Houston, Texas, United States of America

9:45 AM – 10:00 AM 1.4 Out of the Depths: Prompt Forensic Identification of 54 Victims After a 60-Meter Bus Plunge in Guatemala City
Luis Fernando Herrera, MD, National Institute of Forensic Science of Guatemala -INACIF- Guatemala City, Guatemala, Guatemala

10:00 AM – 10:05 AM Questions

10:05 AM – 10:30 AM VISIT EXHIBITS [NOT CME]

10:05 AM – 10:30 AM BREAK [NOT CME]

10:05 AM – 10:30 AM VISIT POSTERS

NAME 59th Annual Meeting
Louisville Marriott Downtown – Louisville, Kentucky
October 17 – 21, 2025

10:30 AM – 12:05 PM	SESSION 2: SKYNET IS BECOMING SELF-AWARE (ARTIFICIAL INTELLIGENCE) Moderators: Nahimarys C. Hernández, MD, Washington DC OCME, Washington, DC, United States of America and Ilaria Tarozzi, MD, Brown University, Providence, Rhode Island, United States of America <i>Marriott Ballroom Salon 6-10, Second Level</i>
10:30 AM – 10:45 AM	2.1 Advances in Medicolegal Death Investigation Data Modernization: Interoperability, Artificial Intelligence, Data Visualization, and Other Novel Projects <i>Michele O. Trofatter, MPH, MLS(ASCP), CDC Foundation, Atlanta, Georgia, United States of America</i>
10:45 AM – 11:00 AM	2.2 WITHDRAWN
11:00 AM – 11:15 AM	2.3 Reimagining Autopsy Documentation using Artificial Intelligence <i>Mihir Joshi, BS, University of California, Los Angeles, Los Angeles, California, United States of America, The Forensic Pathologists LLC, Toledo, Ohio, United States of America, Vikas Kakar, BS, The Ohio State University, Columbus, Ohio, United States of America and Avneesh Pradhan, MS, The Ohio State University, Columbus, Ohio, United States of America</i>
11:15 AM – 11:30 AM	2.4 Machine Learning for the Assessment of Gunshot Wounds <i>Carl J. Schmidt, MD, MPH, University of Michigan, Ann Arbor, Michigan, United States of America and Lucas County Coroner's Office, Toledo, Ohio, United States of America</i>
11:30 AM – 11:45 AM	2.5 Artificial Intelligence and Forensics: Application of Artificial Intelligence to the Classification of Gunshot Wounds <i>Daniel Atherton, MD, University of Alabama Heersink School of Medicine, Bessemer, Alabama, United States of America and Jefferson County Coroner/Medical Examiner's Office, Birmingham, Alabama, United States of America</i>
11:45 AM – 12:00 PM	2.6 The Fox Hollow Murders <i>Steve Ainsworth, Othram, Inc, The Woodlands, Texas, United States of America</i>
12:00 PM – 12:05 PM	Questions
12:05 PM – 2:00 PM	LUNCH (ON YOUR OWN) [NOT CME]
12:05 PM – 1:30 PM	POSTER SESSION P1 – P48 [AUTHORS AT POSTERS 1:00PM – 2:00PM]
2:00 PM – 3:20 PM	SESSION 3 (Part 1): NEW FORENSIC TOYS (TECHNOLOGY) Moderators: Laura D. Knight, MD, Washoe County Regional Medical Examiner's Office, Reno, Nevada, United States of America and Tyler Murray, DO, Baylor University Medical Center, Dallas, Texas, United States of America <i>Marriott Ballroom Salon 6-10, Second Level</i>
2:00 PM – 2:15 PM	3.1 Small Uncrewed Aircraft Systems (sUAS): The Innovation of Drone Technology into the Medical Examiner System of Medicolegal Death Scene Investigations, and Human/Skeletal Remains Searches and Recovery <i>Philip Miller, BS, F-ABMDI, Oklahoma Office of the Chief Medical Examiner, Tulsa, Oklahoma, United States of America</i>
2:15 PM – 2:30 PM	3.2 Synoptic Autopsy Reporting: A Response to the Opioid Crisis <i>Rachel E. Martindale, PA(ASCP), WMU Homer Stryker M.D. School of Medicine, Kalamazoo, Michigan, United States of America</i>
2:30 PM – 2:45 PM	3.3 Development of a Digital Whole Slide Image Database as a Learning Tool for Forensic Histopathology <i>Hannah P. McQueen, MD, Medical University of South Carolina (MUSC), Charleston, South Carolina, United States of America</i>

NAME 59th Annual Meeting
Louisville Marriott Downtown – Louisville, Kentucky
October 17 – 21, 2025

2:30 PM – 2:45 PM	3.3 Development of a Digital Whole Slide Image Database as a Learning Tool for Forensic Histopathology <i>Hannah P. McQueen, MD, Medical University of South Carolina (MUSC), Charleston, South Carolina, United States of America</i>
2:45 PM – 3:00 PM	3.4 Future Forensics: When Man and Machine Merge <i>Gert Saayman, FCFORPath(SA), University of Pretoria, Pretoria, Gauteng, South Africa</i>
3:00 PM – 3:15 PM	3.5 Spatial Computing in Forensic Pathology <i>Christopher Sullivan, MD, MPH, HNL Lab Medicine, Allentown, Pennsylvania, United States of America</i>
3:15 PM – 3:20 PM	Questions
3:20 PM – 3:45 PM	VISIT EXHIBITS [NOT CME]
3:20 PM – 3:45 PM	BREAK [NOT CME]
3:20 PM – 3:45 PM	VISIT POSTERS
3:45 PM – 5:05 PM	SESSION 3 (Part 2): NEW FORENSIC TOYS (TECHNOLOGY) Moderators: Brandi C. McCleskey, MD, Jefferson County Coroner/Medical Examiner Office, Birmingham, Alabama, United States of America and Christopher Sullivan, MD, MPH, HNL Lab Medicine, Allentown, Pennsylvania, United States of America <i>Marriott Ballroom Salon 6-10, Second Level</i>
3:45 PM – 4:00 PM	3.6 From Scalpel to Stylus: Implementing a Paperless Workflow in a Forensic Pathology Office Using iPads and Lean Process Improvement <i>Marcel Castor, MD, DeKalb County Medical Examiner's Office, Decatur, Georgia, United States of America</i>
4:00 PM – 4:15 PM	3.7 Robots, Death, and Forensic Pathology <i>Joseph A. Prahlow, MD, St. Louis University School of Medicine, Department of Pathology, St. Louis, Missouri, United States of America and Office of the Medical Examiner - City of St. Louis, St. Louis, Missouri, United States of America</i>
4:15 PM – 4:30 PM	3.8 Fiberoptic Technology at Autopsy <i>Bryce Whitehead, BS, Office of the Medical Examiner - City of St. Louis, St. Louis, Missouri, United States of America and University of Toledo College of Medicine and Life Sciences, Toledo, Ohio, United States of America</i>
4:30 PM – 4:45 PM	3.9 Phosphatidylethanol (PEth) as a Postmortem Blood Test for Chronic/Recent Alcohol Use <i>Deland Weyrauch, MD, Montana State Medical Examiner's Office, Billings, Montana, United States of America</i>
4:45 PM – 5:00 PM	3.10 Time and Distance in Death investigation: Cryptogenic Cause and Manner of Death: Two Cases and a Literature Review <i>Kody Heubach, DO, Health Sciences Center, West Virginia University, Morgantown, West Virginia, United States of America</i>
5:00 PM – 5:05 PM	Questions

SUNDAY, OCTOBER 19, 2025

GENERAL INFORMATION:

6:00 AM – 8:00 AM	Rigor Run/Walk (Optional) [NOT CME] <i>Sponsored by The Denton Family</i> <i>*Additional Payment Required*</i>
6:45 AM – 8:00 AM	Buffet Breakfast (Registrants and Ticket Holders Only) [NOT CME] <i>Kentucky Ballroom, Ground Level</i>
7:00 AM – 5:00 PM	Registration [NOT CME] <i>Kentucky Ballroom Foyer, Ground Level</i>
8:00 AM – 3:30 PM	Exhibits [NOT CME] <i>Kentucky Ballroom, Ground Level</i>
8:00 AM – 5:00 PM	Posters <i>Kentucky Ballroom Foyer, Ground Level</i>
11:00 AM – 5:00 PM	30 th Annual Randy Hanzlick Memorial Cadaver Open Golf Tournament (Optional) [NOT CME] <i>Sponsored by Artivion, Inc.</i> <i>*Additional Payment Required*</i>
6:00 PM – 8:00 PM	Louis Jares Memorial Bring Your Own Stories Event (Optional) [NOT CME] <i>*RSVP Required*</i> <i>Filly/Thoroughbred, Second Level</i>

COMMITTEE MEETING [NOT CME]:

6:30 PM – 8:00 PM	Scientific Presentations Awards Committee Meeting <i>Skybox, Second Level</i>
-------------------	--

PROGRAM INFORMATION:

8:00 AM – 9:50 AM	SESSION 4: HEY, THERE IS A PATHOLOGIST SHORTAGE (WORKFORCE) Moderators: Adele Lewis, MD, Tennessee Department of Health, Nashville, Tennessee, United States of America and Elizabeth McLeod, MD, MS, Georgia Bureau of Investigation, Atlanta, Georgia, United States of America <i>Marriott Ballroom Salon 6-10, Second Level</i>
8:00 AM – 8:15 AM	4.1 A Practical Approach to the Utilization of Forensic Pathologists' Assistants at the DeKalb County Medical Examiner's Office <i>Gerald T. Gowitt, MD, DeKalb County Medical Examiner's Office, Decatur, Georgia, United States of America</i>
8:15 AM – 8:30 AM	4.2 A Tale of Incompetency <i>Mariana Voudouri, MD, Miami-Dade County Medical Examiner, Miami, Florida, United States of America</i>
8:30 AM – 8:45 AM	4.3 Strengths and Challenges in Autopsy Training for Pathology Residents: A Survey of Forensic Pathology Fellows – Follow up to a Survey of Autopsy Directors <i>Nicolas Kostecky, MD, Western Michigan University Homer Stryker MD School of Medicine, Kalamazoo, Michigan, United States of America</i>
8:45 AM – 9:00 AM	4.4 Addressing the Forensic Pathology Shortage in the United States: Empowering International Forensic Pathologists to Bridge the Gap - A perspective from the NAME Visa Applicant Advisory Committee <i>Clare H. Bryce, MD, Washoe County Regional Medical Examiner's Office, Reno, Nevada, United States of America and Lorenzo Gitto, MD, Cook County Medical Examiner's Office, Chicago, Illinois, United States of America</i>

NAME 59th Annual Meeting
Louisville Marriott Downtown – Louisville, Kentucky
October 17 – 21, 2025

9:00 AM – 9:15 AM	4.5 Forensic Pathology for the Ages: Tarrant County Medical Examiner's Office's Approach to Introducing Forensics from Grade School to Grandparents <i>Stacey L. Murthy, MD, Tarrant County Medical Examiner's Office, Fort Worth, Texas, United States of America</i>
9:15 AM – 9:30 AM	4.6 Educational Outreach in Forensic Pathology: A Framework for Strategic Social Media Use and Policy Development in ME/C Offices <i>Jenna L. Aungst, OMS-IV, Lincoln Memorial University-DeBusk College of Osteopathic Medicine, Knoxville, Tennessee, United States of America</i>
9:30 AM – 9:45 AM	4.7 Enhancing Public Understanding: The Establishment of a Public Education Specialist Position at DeKalb County's Medical Examiner's Office <i>Brittany Godfrey, LFT, LE, DeKalb County Medical Examiner's Office, Decatur, Georgia, United States of America</i>
9:45 AM – 9:50 AM	Questions
9:50 AM – 10:15 AM	VISIT EXHIBITS [NOT CME]
9:50 AM – 10:15 AM	BREAK [NOT CME]
9:50 AM – 10:15 AM	VISIT POSTERS
10:15 AM – 12:05 PM	SESSION 5: CARCERAL CONUNDRUMS Moderators: Jan M. Gorniak, DO, MHSA, MSMed, World Peace Forensic Consulting, LLC, Tallahassee, Florida, United States of America and Shera N. Wanner, MD, University of California San Francisco, San Francisco, California, United States of America <i>Marriott Ballroom Salon 6-10, Second Level</i>
10:15 AM – 11:00 AM	5.1 Prison 101: Conversation with a Correctional Medicine Physician on Deaths in Carceral Facilities <i>Marc F. Stern, MD, MPH, University of Washington School of Public Health, Seattle, Washington, United States of America and Deland Weyrauch, MD, Montana State Medical Examiner's Office, Billings, Montana, United States of America</i>
11:00 AM – 11:15 AM	5.2 An Evolving Novel Synthetic Opioid Drug Market with Impacts on Medicolegal Death Investigations and Forensic Toxicology Interpretation <i>Alex J. Krotulski, PhD, Center for Forensic Science Research and Education, Horsham, Pennsylvania, United States of America</i>
11:15 AM – 11:30 AM	5.3 Truth, Trauma, and the Death Certificate: Overdose Deaths, Postconviction Amendments, and Implications for Missing and Murdered Indigenous People and Indian Country <i>Madison Esposito, MPH, University of Minnesota, Minneapolis, Minnesota, United States of America</i>
11:30 AM – 11:45 AM	5.4 Can 4-ANPP Concentrations Differentiate Illicit from Licit Fentanyl? <i>Laura M. Labay, PhD, NMS Labs, Horsham, Pennsylvania, United States of America</i>
11:45 AM – 12:00 PM	5.5 WITHDRAWN
12:00 PM – 12:05 PM	Questions
12:05 PM – 1:30 PM	LUNCH (ON YOUR OWN) [NOT CME]
12:05 PM – 1:30 PM	POSTER SESSION P49 – P96 [AUTHORS AT POSTERS 12:30PM – 1:30PM]

NAME 59th Annual Meeting
Louisville Marriott Downtown – Louisville, Kentucky
October 17 – 21, 2025

1:30 PM – 3:05 PM	SESSION 6: PPP, PART 1 (PREGNANCY, PEDS, AND PLACENTA) Moderators: Dianne Little, MBBS, Retired Forensic Pathologist, Ryde, NSW, Australia and Ljubisa J. Dragovic, MD, Oakland County Medical Examiner, Pontiac, Michigan, United States of America <i>Marriott Ballroom Salon 6-10, Second Level</i>
1:30 PM – 2:00 PM	6.1 Certification of Pediatric Deaths <i>Kathryn Pinneri, MD, Montgomery County Medical Examiner's Office, Conroe, Texas, United States of America</i>
2:00 PM – 2:30 PM	6.2 Autopsy of the Pregnant Woman: A Protocol for Postmortem Pregnancy Testing and the Pitfalls of Jurisprudence <i>Marianne Hamel, MD, PhD, Jersey Shore Forensics, Bethlehem, Pennsylvania, United States of America</i>
2:30 PM – 2:45 PM	6.3 Placental and Neuropathologic Correlations in Perinatal Forensic Autopsies <i>Michael Harrell, MD, OCME, Oklahoma, Oklahoma, United States of America and Jolee Suddock, DO, OCME, Oklahoma, Oklahoma, United States of America</i>
2:45 PM – 3:00 PM	6.4 Amniotic fluid embolism: A Diagnosis in Need of a Mechanism <i>Katherine F. Maloney, MD, Erie County Medical Examiner's Office, Buffalo, New York, United States of America and Miranda Klassen, BS, Amniotic Fluid Embolism Foundation, Vista, California, United States of America</i>
3:00 PM – 3:05 PM	Questions
3:05 PM – 3:30 PM	VISIT EXHIBITS [NOT CME]
3:05 PM – 3:30 PM	BREAK [NOT CME]
3:05 PM – 3:30 PM	VISIT POSTERS
3:30 PM – 5:35 PM	SESSION 7: PPP, PART 2 (PERINATAL, PEDS, AND PUBLIC HEALTH) Moderators: Kristinza W. Giese, MD, Office of the Chief Medical Examiner – DC, Washington, DC, United States of America and Gregory A. Schmunk, MD, Urbandale Forensics, PC, Urbandale, Iowa, United States of America <i>Marriott Ballroom Salon 6-10, Second Level</i>
3:30 PM – 4:00 PM	7.1 Pediatric Neuropathology in Forensic Autopsy <i>Jolee Suddock, DO, OCME, Oklahoma City, Oklahoma, United States of America and Lorraina Robinson, DO, MS, OCME, Oklahoma City, Oklahoma, United States of America</i>
4:00 PM – 4:15 PM	7.2 Manner of Death and Ethical Dilemmas in Perinatal Pediatric Deaths <i>Sam Cuniff, BA, Saint Louis University School of Medicine, Saint Louis, Missouri, United States of America</i>
4:15 PM – 4:30 PM	7.3 Interagency Collaboration, Medicolegal Investigation, and Postmortem Genetic Testing in the Evaluation of Suspicious Pediatric Deaths <i>Maneesha Pandey, MD, Forensic Medical, Kansas City, Kansas, United States of America and Alfonzo Halfin, MD, Forensic Medical, Kansas City, Kansas, United States of America</i>
4:30 PM – 4:45 PM	7.4 Are Non-natural Deaths Underreported? A Preliminary Comparison of Non-natural Deaths in Coroner Counties, Medical Examiner Counties, and Coroner Counties with a State Medical Examiner <i>David L. Horvath, DO, University of Tennessee Medical Center, Knoxville, Tennessee, United States of America</i>

NAME 59th Annual Meeting
Louisville Marriott Downtown – Louisville, Kentucky
October 17 – 21, 2025

4:45 PM – 5:00 PM	7.5 Improving Community Health through Drug Overdose Dashboards: Insights from STORM and TRUST <i>Theodore T. Brown, MD, Arkansas State Crime Laboratory, Little Rock, Arkansas, United States of America</i>
5:00 PM – 5:15 PM	7.6 Are We At The End of the Opioid Epidemic? A Challenging Public Health Question <i>Thomas Gilson, MD, Cuyahoga County Medical Examiner's Office, Cleveland, Ohio, United States of America</i>
5:15 PM – 5:30 PM	7.7 Legionnaires' Disease and SARS-CoV-2/COVID-19 Disease Outbreaks at Two Illinois Veteran's Nursing Homes: The Public Health and Medicolegal Implications for Death Investigation <i>Scott Denton, MD, McLean County Coroners Office, Bloomington, Illinois, United States of America</i>
5:30 PM – 5:35 PM	Questions

MONDAY, OCTOBER 20, 2025

GENERAL INFORMATION:

6:45 AM – 8:00 AM	Buffet Breakfast (Registrants and Ticket Holders Only) [NOT CME] <i>Kentucky Ballroom, Ground Level</i>
8:00 AM – 4:00 PM	Exhibits [NOT CME] <i>Kentucky Ballroom, Ground Level</i>
7:00 AM – 5:00 PM	Registration [NOT CME] <i>Kentucky Ballroom Foyer, Ground Level</i>
8:00 AM – 5:00 PM	Posters <i>Kentucky Ballroom Foyer, Ground Level</i>
12:00 PM – 1:30 PM	Voices: Amplify, Elevate, Celebrate Luncheon (Optional) <i>Sponsored by our Platinum Level Corporate Partner, Forensic Pathology Staffing</i> <i>*Additional Payment Required*</i> <i>Bluegrass I – II, Second Level</i>
6:30 PM – 8:30 PM	Board of Directors Reception (Invitation Only) [NOT CME] <i>Rose, Second Level</i>

PROGRAM INFORMATION:

7:00 AM – 8:00 AM	OPTIONAL WORKSHOP: LEARN TO LEAD WITH INTEGRITY AND INNOVATION FROM FORENSIC PATHOLOGY LEADERS Moderator: Michelle Aurelius, MD, NC Office of the Chief Medical Examiner, Raleigh, North Carolina, United States of America <i>Bluegrass I – II, Second Level</i>
8:00 AM – 9:50 AM	NAME Business Meeting [NOT CME] <i>Marriott Ballroom Salon 6-10, Second Level</i>
9:50 AM – 10:20 AM	VISIT EXHIBITS [NOT CME]
9:50 AM – 10:20 AM	BREAK [NOT CME]
9:50 AM – 10:20 AM	VISIT POSTERS
10:20 AM – 12:00 PM	NAME Business Meeting [NOT CME] <i>Marriott Ballroom Salon 6-10, Second Level</i>
12:00 PM – 1:30 PM	LUNCH (ON YOUR OWN) [NOT CME]
12:00 PM – 1:30 PM	POSTER SESSION P97 – P144 [AUTHORS AT POSTERS 12:30PM – 1:30PM]

NAME 59th Annual Meeting
Louisville Marriott Downtown – Louisville, Kentucky
October 17 – 21, 2025

1:30 PM – 3:35 PM	SESSION 8: I'M FROM THE GOVERNMENT AND I'M HERE TO HELP Moderators: Candace H. Schoppe, MD, San Diego County Medical Examiner's Office, San Diego, California, United States of America and William C. Rodriguez, III, PhD, Office of the Chief Medical Examiner, Blatimore, Maryland, United States of America <i>Marriott Ballroom Salon 6-10, Second Level</i>
1:30 PM – 1:45 PM	8.1 WITHDRAWN
1:45 PM – 2:00 PM	8.2 Innovation Meets Investigation: Elevating Medicolegal Death Investigation Through the Bureau of Justice Assistance's Forensics Training and Technical Assistance Program <i>Kelly Keyes, RTI International, Research Triangle Park, North Carolina, United States of America</i>
2:00 PM – 2:15 PM	8.3 The Medical Examiner Improvement in Oregon Workgroup <i>Sean Hurst, MD, Oregon State Police - Medical Examiner Division, Clackamas, Oregon, United States of America</i>
2:15 PM – 2:30 PM	8.4 American Femicide as a Function of Gun Ownership: A Comparison of Two States <i>Abigail L. Alexander, MD, MPH, New Hampshire Office of the Chief Medical Examiner, Concord, New Hampshire, United States of America and Dartmouth Geisel School of Medicine, Hanover, New Hampshire, United States of America</i>
2:30 PM – 2:45 PM	8.5 Dead Wrong: Is Flawed Case Screening Masking the Next Public Health Crisis? <i>Michelle Rippy, EdD, California State University East Bay, Hayward, California, United States of America</i>
2:45 PM – 3:00 PM	8.6 The SUDC Registry and Research Collaborative: Lessons Learned, Future Opportunities <i>Laura Gould, MSc, NYU Grossman School of Medicine, New York, New York, United States of America</i>
3:00 PM – 3:15 PM	8.7 Interactive Discussion of Cases with Challenging Manners of Death <i>Advisory: This presentation contains material that some viewers may find disturbing or upsetting</i> <i>Ilaria Tarozzi, MD, Department of Pathology and Laboratory Medicine, Brown University, Providence, Rhode Island, United States of America</i>
3:15 PM – 3:30 PM	8.8 New Technology Applied to Timeless Principles: The Nexus Between Crime Scene Analysis and Autopsy Findings <i>Maria S. Conte, MD, JD, Institute of Forensic Sciences, San Juan, Puerto Rico</i>
3:30 PM – 3:35 PM	Questions
3:35 PM – 4:00 PM	VISIT EXHIBITS [NOT CME]
3:35 PM – 4:00 PM	BREAK [NOT CME]
3:35 PM – 4:00 PM	VISIT POSTERS

NAME 59th Annual Meeting
Louisville Marriott Downtown – Louisville, Kentucky
October 17 – 21, 2025

4:00 PM – 5:35 PM	SESSION 9: YOU CAN'T HANDLE THE TRUTH (LEGAL) Moderators: Gregory A. Vincent, MD, State of Connecticut Office of Chief Medical Examiner, Farmington, Connecticut, United States of America and Joy O. Edegbe, MD, District Nine Medical Examiner, Orlando, Florida, United States of America <i>Marriott Ballroom Salon 6-10, Second Level</i>
4:00 PM – 4:15 PM	9.1 Eight-Year Review of the Swift Toxicology of Opioid-Related Mortalities (STORM) Project <i>Gemma Harkin, MPH, Western Michigan University Homer Stryker MD School of Medicine, Kalamazoo, Michigan, United States of America</i>
4:15 PM – 4:30 PM	9.2 We Can Work It Out: A Lawyer's Proposal to the Problems Associated with Forensic Conclusions of Cause and Manner of Death <i>Allison M. Lewis, JD, The Legal Aid Society, New York, New York, United States of America</i>
4:30 PM – 4:45 PM	9.3 Doing Time: Expert Witness Testimony <i>Courtney Lawrence, Georgia Bureau of Investigation, Decatur, GA, United States of America</i>
4:45 PM – 5:00 PM	9.4 Electronic Death Certificate Workflows and the Busy Forensic Pathologist: A Thought Experiment <i>Jay Stahl-Herz, MD, Brooklyn Forensics LLC, Milford, Connecticut, United States of America</i>
5:00 PM – 5:15 PM	9.5 Self-Monitoring Your Practice: The Forensic Pathology Journey <i>Odey Chukwuemeka Ukpo, MD, MS, County of Los Angeles Department of Medical Examiner, Los Angeles, California, United States of America</i>
5:15 PM – 5:30 PM	9.6 Causes of Death with Undetermined Manners <i>Maura E. DeJoseph, DO, OCME, Farmington, Connecticut, United States of America</i>
5:30 PM – 5:35 PM	Questions

TUESDAY, OCTOBER 21, 2025

GENERAL INFORMATION:

6:45 AM – 8:00 AM	Buffet Breakfast (Registrants and Ticket Holders Only) [NOT CME] <i>Kentucky Ballroom, Ground Level</i>
7:00 AM – 12:00 PM	Registration [NOT CME] <i>Kentucky Ballroom Foyer, Ground Level</i>
7:00 AM – 8:00 AM	The Business of Forensic Pathology Breakfast (Optional) <i>*Additional Payment Required*</i> <i>Bluegrass I – II, Second Level</i>

PROGRAM INFORMATION:

8:00 AM – 9:50 AM	SESSION 10: X NEVER, EVER MARKS THE SPOT (ANTHROPOLOGY) Moderators: Muhammad Ahmad Faraz, MBBS, Post Graduate Medical Institute, Lahore, Lahore, Pakistan and Deirdre Amaro, MD, Utah Office of the Medical Examiner, Taylorsville, Utah, United States of America <i>Marriott Ballroom Salon 6-10, Second Level</i>
8:00 AM – 8:15 AM	10.1 Biomechanical Analysis of Hyoid Bone Fractures in Fresh Cadaveric Specimens <i>Lorenzo Gitto, MD, Cook County Medical Examiner's Office, Chicago, Illinois, United States of America</i>

NAME 59th Annual Meeting
Louisville Marriott Downtown – Louisville, Kentucky
October 17 – 21, 2025

8:15 AM – 8:30 AM	10.2 Seeing Eye to Eye? Comparing Forensic Pathologist and Radiologist Interpretations of Cervical Spine Injuries on Postmortem Computed Tomography <i>Heather S. Jarrell, MD, Office of the Medical Investigator, Albuquerque, New Mexico, United States of America</i>
8:30 AM – 8:45 AM	10.3 That Cranium is Strange Looking: Human Variation, Congenital Development, and Scavenging of Human and Hydrocephalic Calf Craniums <i>William Rodriguez III, PhD, Office of the Chief Medical Examiner, Baltimore, Maryland, United States of America</i>
8:45 AM – 9:00 AM	10.4 Multidisciplinary Approaches to Dismemberment Cases: Integrating Forensic and Anthropology <i>Jennifer L. Hammers, DO, Jennifer Hammers Pathology LLC, Pittsburgh, Pennsylvania, United States of America and Duquesne University College of Osteopathic Medicine, Pittsburgh, Pennsylvania, United States of America</i>
9:00 AM – 9:15 AM	10.5 Body and the Beast: Investigating Animal-Related Trauma through Postmortem Imaging <i>Jamie Marie Elifritz, MD, FRG, Anderson, South Carolina, United States of America and Office of the Medical Investigator, Albuquerque, New Mexico, United States of America and Heather S. Jarrell, MD, Office of the Medical Investigator, Albuquerque, New Mexico, United States of America</i>
9:15 AM – 9:30 AM	10.6 Reassessing Forensic Significance through Radiocarbon Dating: A Cautionary Tale from the Oklahoma Office of the Chief Medical Examiner <i>Timothy P Gocha, PhD, Oklahoma Office of the Chief Medical Examiner, Tulsa, Oklahoma, United States of America</i>
9:30 AM – 9:45 AM	10.7 Digging into Forensic Investigative Genetic Genealogy: Transforming the Identification of Unidentified Human Remains <i>Erin Gorden, Signature Science, LLC, Charlottesville, Virginia, United States of America</i>
9:45 AM – 9:50 AM	Questions
9:50 AM – 10:15 AM	BREAK [NOT CME]
10:15 AM – 11:50 AM	SESSION 11: CADAVEROUS CORNICOPIA Moderators: Marcel Castor, MD, Dekalb County Medical Examiner Office, Decatur, Georgia, United States of America and Hannah C. Jarvis, MBBS, Harris County Institute of Forensic Sciences, Houston, Texas, United States of America <i>Marriott Ballroom Salon 6-10, Second Level</i>
10:15 AM – 10:30 AM	11.1 Systematized International Capacity Development for Forensic Pathology in Low-Resource Jurisdictions: A Proposed Model <i>Alfredo Eugene Walker, FRCPath, DMJ (Path), MBBS, University of Ottawa, Ottawa, Ontario, Canada and Eastern Ontario Regional Forensic Pathology Unit, Ottawa, Ontario, Canada</i>
10:30 AM – 10:45 AM	11.2 A Bloody Surprise: Case Report of Fibrinous Pericarditis in a Patient with Elevated Vitreous Urea Nitrogen (VUN) <i>Jan Gorniak, DO, MHSA, MSMEd, D-ABMDI, World Peace Forensic Consulting, Tallahassee, Florida, United States of America</i>
10:45 AM – 11:00 AM	11.3 Victims of the Volcano: A Survey of Fatalities in Mount Rainier National Park that Challenge Medicolegal Death Investigation and Death Certification <i>Nicole K. Johnson, DO, MS, Pierce County Medical Examiner's Office, Tacoma, Washington, United States of America and Karen Cline-Parhamovich, DO, Pierce County Medical Examiner's Office, Tacoma, Washington, United States of America</i>

NAME 59th Annual Meeting
Louisville Marriott Downtown – Louisville, Kentucky
October 17 – 21, 2025

11:00 AM – 11:15 AM	11.4 WITHDRAWN
11:15 AM – 11:30 AM	11.5 Human Spaceflight: Unique Considerations for Medicolegal Death Investigations <i>Edward L. Mazuchowski, MD, PhD, HNL Lab Medicine, Allentown, Pennsylvania, United States of America</i>
11:30 AM – 11:45 AM	11.6 The Smoking Gun: a Potentially Significant Contributor to Evidence of Close-Range Firing <i>Garrett T. Phillips, MD, Bexar County Medical Examiner's Office, San Antonio, Texas, United States of America</i>
11:45 AM – 11:50 AM	Questions
12:00 PM – 2:00 PM	NAME Luncheon & Awards Presentations (Registrants and Ticket Holders Only) [NOT CME] Milton Helpern Laureate Award Lecture James R. Gill, MD will receive the Milton Helpern Laureate Award (see Page 47 for Details) <i>Kentucky Ballroom, Ground Level</i>
2:00 PM – 3:20 PM	SESSION 12 (Part 1): THE SPICE MUST FLOW (TOX) Moderators: Heather S. Jarrell, MD, Office of the Medical Investigator, UNM Health Sciences Center, Albuquerque, New Mexico, United States of America and Alexander F. Blank, MD, Miami-Dade County Medical Examiner Department, Miami, Florida, United States of America <i>Marriott Ballroom Salon 6-10, Second Level</i>
2:00 PM – 2:15 PM	12.1 Cases Comparisons of Blood, Vitreous Fluid, and Urine (Where Available): Update on Drug Screen Findings in Over 200 Cases <i>Laureen J. Marinetti, PhD, Axis Forensic Toxicology, Indianapolis, Indiana, United States of America</i>
2:15 PM – 2:30 PM	12.2 Novel Autopsy Method for the Rapid Detection of Calcium Oxalate Crystals in Two Cases of Ethylene Glycol Poisoning: Scrape Smear may be a More Sensitive Method Compared to Kidney Histology <i>David J. Keep, MD, Lake County Coroner's Office, Mentor, Ohio, United States of America</i>
2:30 PM – 2:45 PM	12.3 The Utility of UV/IR Photography in Identification of Hidden Elements to Aid in Identification and Investigation <i>Joseph Fortin, Atrium Health Wake Forest School of Medicine, Winston Salem, North Carolina, United States of America</i>
2:45 PM – 3:00 PM	12.4 Synthetic Cannabinoid Prevalence in Prison Deaths <i>Sara E. Walton, MS, Center for Forensic Science Research and Education, Horsham, Pennsylvania, United States of America</i>
3:00 PM – 3:15 PM	12.5 The Role of Autopsy in Alcohol Use Disorder: A Retrospective Review <i>Michelle A. Jorden, MD, Santa Clara County Office of the Medical Examiner, San Jose, California, United States of America</i>
3:15 PM – 3:20 PM	Questions
3:20 PM – 3:30 PM	BREAK [NOT CME]

NAME 59th Annual Meeting
Louisville Marriott Downtown – Louisville, Kentucky
October 17 – 21, 2025

3:30 PM – 4:35 PM	SESSION 12 (Part 2): THE SPICE MUST FLOW (TOX) Moderators: Lauren Nichole Huddle, MD, North Dakota State Forensic Examiner's Office, Bismarck, North Dakota, United States of America and Adam J. Covach, MD, Fond du Lac County Medical Examiner's Office, Fond du Lac, Wisconsin, United States of America <i>Marriott Ballroom Salon 6-10, Second Level</i>
3:30 PM – 3:45 PM	12.6 Postmortem Formation of Ethanol in Vitreous Fluid <i>Brianna Peterson, PhD, NMS Labs, Horsham, Pennsylvania, United States of America</i>
3:45 PM – 4:00 PM	12.7 Sodium Azide: Death and Risk in 700mg <i>Stacey Chepren, MFS, MSc, United States Air Force, Davis-Monthan AFB, Arizona, United States of America and International Association of Coroners & Medical Examiners, Las Vegas, Nevada, United States of America</i>
4:00 PM – 4:15 PM	12.8 Utilizing In-Suite Immunoassay Screening as a Triage Tool for Autopsy Caseload Management <i>Edward A. Reedy, MD, PhD, Alabama Dept of Forensic Sciences, Montgomery, Alabama, United States of America</i>
4:15 PM – 4:30 PM	12.9 "Tranq-Dope," "Benzo-Dope," and Modern Speedballs: Adulteration of the Illicit Fentanyl Supply Complicates Postmortem Investigations <i>Donna M. Papsun, MS, NMS Labs, Horsham, Pennsylvania, United States of America</i>
4:30 PM – 4:35 PM	Questions
4:35 PM	Meeting Adjourns

POSTER PRESENTATIONS:

*Posters P1-P48 must be on the assigned board by Saturday, October 18 at 8:00 AM and remain posted until 5:00 PM.
Posters P49-P96 must be on the assigned board by Sunday, October 19 at 8:00 AM and remain posted until 5:00 PM.
Posters P97-P144 must be on the assigned board by Monday, October 20 at 8:00 AM and remain posted until 5:00 PM. NAME is not responsible for posters left on the board after 5:00 PM on the day of your presentation.*

It is required that presenters be present at their posters during the following presentation times for discussion of their posters with meeting attendees:

P1 – P48: Saturday, October 18, 1:00 PM – 2:00 PM

P49 – P96: Sunday, October 19, 12:30 PM – 1:30 PM

P97 – P144: Monday, October 20, 12:30 PM – 1:30 PM

P1 *In Utero* Assault Could Prove Fatal After 36 Years: An Unusual Case of Epileptogenic Porencephaly

Matthew Stenerson, MS, Department of Pathology and Laboratory Medicine, University of Wisconsin School of Medicine and Public Health, Madison, Wisconsin, United States of America

P2 Left Dominant Arrhythmogenic Cardiomyopathy, Active Phase: Two Case Reports Highlighting Genetic and Pathologic Insights

Jessica Schmitt, MD, ARUP Laboratories, Salt Lake City, Utah, United States of America and University of Utah, Salt Lake City, Utah, United States of America

P3 Death due to Arthrogryposis and Associated Comorbidities: A Case Report

Anne A. Nelson, BS, Department of Pathology, Saint Louis University School of Medicine, Saint Louis, Missouri, United States of America

P4 When Sore Throats Turn Deadly: Two Fatal Cases of *Streptococcus constellatus* with Deep Neck and Mediastinal Spread

Cecilia Dusek, MD, UT Southwestern, Dallas, Texas, United States of America

P5 Little Bullets but Big Impacts

Tia Nguyen Tran, BS, Saint Louis University School of Medicine, Saint Louis, Missouri, United States of America

P6 WITHDRAWN

P7 Fatal Case of Severe Meconium Aspiration Syndrome in a Neonate Following Out-of-Hospital Water Birth

Cristina Fernandez Gonzalez de la Vega, MD, Department of Pathology, Medical College of Wisconsin, Milwaukee, Wisconsin, United States of America

P8 When Lungs Don't Work: Fatal Renal Pathology in Neonates

Blair E. Stewig, BSc, UND School of Medicine & Health Sciences, Grand Forks, North Dakota, United States of America

P9 Thick Blood: Fatal Budd-Chiari Syndrome in the Setting of Dehydration

Margaret Smith, MD, University of Rochester Department of Pathology and Laboratory Medicine, Rochester, New York, United States of America

P10 Sudden Cardiac Death from an Anomalous Origin of a Coronary Artery: A Rare but Critical Diagnosis

Michelle Kao, MS2, Saint Louis University School of Medicine, St. Louis, Missouri, United States of America

P11 Anesthesia-Related Deaths: A Case Series

Eric B. Lu, Saint Louis University School of Medicine, St. Louis, Missouri, United States of America

P12 A Rare Case of Osteogenesis Imperfecta in an Adult

Lorenzo Gitto, MD, University of Illinois Chicago, Chicago, Illinois, United States of America

P13 Death, Drug, and Detectives: A Case Study of a Pennsylvania Cohort of 3-Methylfentanyl Overdoses

Alexander Balacki, MS, Montgomery County Coroner's Office, Eagleville, Pennsylvania, United States of America

P14 Increased Incidence of Invasive Group A Streptococcus Fatalities in Southern Wisconsin

Molly F. Haines, University of Wisconsin-Madison, Madison, Wisconsin, United States of America

P15 Optimizing Postmortem Microbiology: Enhancing Insights Through Strategic Sampling

Brendan Camp, DO, MPH, Beth Israel Deaconess Medical Center, Boston, Massachusetts, United States of America

P16 An Unusual Presentation of Nonpseudomonal Ecthyma Gangrenosum of the Oral Cavity from Oropharyngeal Bacterial Species in an Immunosuppressed Patient: A Case Report

Michael Ann Priddy-Arrington, MD, Wake Forest School of Medicine, Winston-Salem, North Carolina, United States of America

P17 Heterotopic Pregnancy in the Forensic Setting

Lorraina J. Robinson, DO, MS, Oklahoma Office of the Chief Medical Examiner, Oklahoma City, Oklahoma, United States of America

P18 Methamphetamine Use in Asthma Exacerbations: A Multiple Case Study

Dashiell Wuller, BS, Saint Louis University School of Medicine, St. Louis, Missouri, United States of America

P19 The New Fentanyl: A Case Series of Nitazene Fatalities on the Texas Gulf Coast

Gilberto Vento, MD, University of Texas Medical Branch, Galveston, Texas, United States of America

P20 Train Video Cam in Elucidating Manner Of Death In the County of Santa Clara

Shatreen Masshoor, MD, Stanford University Medical Center, Palo Alto, California, United States of America

P21 Beyond the Cysts: A Rare Case of Splenic Artery Aneurysm Rupture in Autosomal Recessive Polycystic Kidney Disease

Megan Matlock, DO, University of New Mexico, Albuquerque, New Mexico, United States of America and New Mexico Office of the Medical Investigator, Albuquerque, New Mexico, United States of America

P22 A Fatal Cervical Injury during Bull Riding: A Case Report and Review of the Literature

Julian Samuel, MBBS, Harris County Institute of Forensic Sciences, Houston, Texas, United States of America

P23 Death by Triglycerides: A Multifaceted Case of Dyslipidemia, Obesity, and Polycystic Ovary Syndrome Resulting In Lethal Acute Pancreatitis

Heather L. Williams, CMI, M3, Jacobs School of Medicine and Biomedical Sciences at the University at Buffalo, Buffalo, New York, United States of America

P24 An Unusual Suicide Involving an Air Rifle: Case Report and Review of the Forensic Literature

Andrea Leal Lopez, MD, University of Pittsburgh Medical Center, Pittsburgh, Pennsylvania, United States of America

P25 Calcified Clues to Cause of Death: Forensic Imaging of Atherosclerotic Calcification in Decedents at the Tarrant County Medical Examiner's Office

Katherine Atamanczuk Rall, DO Candidate, William Carey University College of Osteopathic Medicine, Hattiesburg, Mississippi, United States of America

P26 Sudden Cardiac Death in a Young Female with Bileaflet Mitral Valve Prolapse and Mitral Annular Disjunction: A Case Report Highlighting an Underrecognized Arrhythmogenic Substrate

John Bradley, MD, University of Kentucky, Lexington, Kentucky, United States of America

P27 Challenges in Death Certification: Trends and Contributing Factors in Undetermined Manner of Death (2018–2024) from Two Large Medical Examiner Offices

Vic Reason, MD, MPH, Cook County Medical Examiner's Office, Chicago, Illinois, United States of America

P28 Fatal Gas Gangrene from a Dog Bite: A Case Study and Review of Animal Bite Workups in Postmortem Investigation

Sara Beardsley-Eide, DO, Stony Brook University Hospital, Stony Brook, New York, United States of America

P29 A Rare Case of Suicide by Powder-Actuated Nail Gun

Taylor J. Perrye, OMS-III, Nova Southeastern University Dr. Kiran C. Patel College of Osteopathic Medicine, Clearwater, Florida, United States of America

P30 Sarcina: A Case Report of a Sudden Demise, the Unexpected Intrathoracic Autopsy Findings, and the Gut-Busting Culprit

Katherine J. Bellas, DO, University at Buffalo, Buffalo, New York, United States of America and Kaleida Health, Buffalo, New York, United States of America

P31 Fatal Falls from the US–Mexico Border Wall: A Retrospective Forensic and Biomechanical Analysis from El Paso, Texas

Alejandro Partida Contreras, MD, Texas Tech University Health Sciences Center, El Paso, Texas, United States of America

P32 Deciphering the Multiple Gunshot Wound Suicide: A Series of 21 Cases

Kori L. Mecklenburg, MD, Cedars Sinai Medical Center, Los Angeles, California, United States of America

P33 The Impact of Scalp Hair on Gunshot Residue Deposition: A Forensic Approach to Range of Fire Determination

Allison H.H. Martin, MD, Cook County Medical Examiner's Office, Chicago, Illinois, United States of America

P34 Trends in Deaths Attributed to Mitrugynine: The Georgia Bureau of Investigation Perspective

Rachel Summers, BS, Florida International University Herbert Wertheim College of Medicine, Miami, Florida, United States of America

P35 A Rare Report of Equine Peri- and Postmortem Scavenging of Human Remains

Ana M. Chang, OMSIII, PhD, Pacific Northwest University of Health Sciences College of Osteopathic Medicine, Yakima, Washington, United States of America

P36 Workforce Characteristics of Senior Physician Roles in United States Medical Examiner Offices

Bethany Faust, MD, Yale University School of Medicine, Department of Pathology, New Haven, Connecticut, United States of America

P37 Assessing the Impact of Religion and Culture on Autopsy Practice and Public Health

Caroline C. Pack, BSc (MPH Candidate), Dartmouth College, Hanover, New Hampshire, United States of America

P38 Identifying Risk Factors in Child Abuse-Homicides: A Forensic Autopsy Case Study in the State of Maryland, 2016-2023

Elaina R. Mufareh, BS, University of Maryland, Baltimore, Baltimore, Maryland, United States of America

P39 A 25-Year Retrospective Study on Bridge/Overpass-Related Deaths in St. Louis

David Valencia, BSE, Saint Louis University School of Medicine, St. Louis, Missouri, United States of America

P40 Postmortem Genetic Testing: Do the Genes Fit...?

Lauren Brilliant, BS, University of Nevada - Reno School of Medicine (UNR Med), Reno, Nevada, United States of America and Marie Hashitani, BS, University of Nevada - Reno School of Medicine (UNR Med), Reno, Nevada, United States of America

P41 Beyond the Blow: Exploring Post-Traumatic Hydrocephalus and Ventriculomegaly: A Case Report

Addie M. Hancock, DO, Wake Forest School of Medicine, Winston Salem, North Carolina, United States of America

P42 Demographics of Chronic Traumatic Encephalopathy Cases Received From Medical Examiner and Coroner Offices at the UNITE Brain Bank

Daniel Kirsch, BA, Boston University School of Medicine, Boston, Massachusetts, United States of America, Chronic Traumatic Encephalopathy Center, Boston University, Boston, Massachusetts, United States of America, VA Boston Healthcare System, Boston, Massachusetts, United States of America and Department of Pathology and Laboratory Medicine, Boston University, Boston, Massachusetts, United States of America

P43 Not Trash: A Case Series of Solid Waste Truck/Facility Compactor Deaths in Vermont

Alayna M Westcom, MD, University of Vermont Medical Center, Burlington, Vermont, United States of America

P44 r/ForensicPathology: Observations and Potential Implications from a Public Online Discussion Forum on Forensic Pathology Education and Recruitment

Riley Jepkema, BS, University of Michigan Medical School, Ann Arbor, Michigan, United States of America

P45 A Case of Mechanical Asphyxiation Related to Military Training

Amanda Saunders, MD, MBA, Walter Reed National Military Medical Center, Bethesda, Maryland, United States of America

P46 Shared and Withheld: Communication of Emotion in Death-Focused Medical Specialties

Tyler Dzuba, MSLS, School of Medicine & Dentistry, University of Rochester, Rochester, New York, United States of America

P47 An Unusual Case of Suicide by Circular Saw

Hannah Marissa Newberry, MS, University of Louisville School of Medicine, Louisville, Kentucky, United States of America

P48 A Rare Case of Death Due to Direct Penetrating Carotid Artery Trauma from Exploding Vaporizer Pen Resulting in Cerebral Infarction

Fangnan E. Ndam, MD, Henry Ford St John Hospital, Detroit, Michigan, United States of America

P49 Sudden Death of a Young Man with Seizures and Prior Brain Tumor Resection

Alison M. Maniace, BA, Western Michigan University Homer Stryker MD School of Medicine, Kalamazoo, Michigan, United States of America

P50 Underlying Cause for Concern: State-Level Predictors of Poorly Defined Deaths During Periods of Elevated Mortality

Molly E. Pierson, MPH, Celia S. Weatherhead School of Public Health and Tropical Medicine, Tulane University, New Orleans, Louisiana, United States of America

P51 Postmortem Eye Retention in a Regional Medical Examiner's Office

Aimee E. Carpenter, BS, Western Michigan University Homer Stryker MD School of Medicine, Kalamazoo, Michigan, United States of America and Matthew J. Hartwig, BS, Western Michigan University Homer Stryker MD School of Medicine, Kalamazoo, Michigan, United States of America

P52 From Intake to Lethal Outcomes: Postmortem Analyses of Carceral Healthcare in South Carolina

Brittany Wilson, DO, Medical University of South Carolina, Charleston, South Carolina, United States of America

P53 Cough Dropped Dead: A Rare Antemortem Case Report of Lozenge-Induced Acquired Methemoglobinemia in the Presence of G6PD Deficiency and Twin Pregnancy

Jeremy J. Myers, BS, Rocky Vista University, Parker, Colorado, United States of America

P54 Updates in Normal Organ Weights: Review of Tools for Adult and Pediatric Organ Weight References from the College of American Pathologists

Meagan Chambers, MD, MS, MSc, Stanford University, Stanford, California, United States of America

P55 N₂O Other Explanation: Canisters, Clots, and Conundrums

Briana Fernandez, BS, Baylor College of Medicine, Houston, Texas, United States of America

P56 Case Report: Congenital Cyst Causing Lethal Asphyxia in a One-month-old Infant

Danielle M. Lombardo, MD, University of Wisconsin Hospitals and Clinics, Madison, Wisconsin, United States of America

P57 Accidental Death Due to Self-Inflicted Negligent Discharge of a Gun in a Motor Vehicle Collision

Sarah J. Lewis, DO, Tulane University School of Medicine Department of Pathology & Laboratory Medicine, New Orleans, Louisiana, United States of America

P58 A Longitudinal Review of Homicide Gunshot Wound Fatalities in Cuyahoga County, Ohio: A Retrospective Analysis of Trends in Gunshot Wound Lethality

Suzanna Gail Bruns, BS, Case Western Reserve University, Cleveland, Ohio, United States of America

P59 WITHDRAWN

P60 Beyond the Bruises: Unraveling a Disguised Diagnosis of Fatal Infantile Appendicitis

Nahimays C. Hernández, MD, District of Columbia Office of the Chief Medical Examiner, Washington, DC, United States of America

P61 WITHDRAWN

P62 Subgaleal Hematoma from Hair Pulling in Intimate Partner Violence: A Forensic Case Study
Sarah A Boring, BSc, Jennifer Hammers Pathology, LLC, Beaver Falls, Pennsylvania, United States of America

P63 Clinicopathological Characteristics in Autopsy-Diagnosed Aortic Dissections and Ruptures: A Two-Center Retrospective Forensic Pathological Study
Shubham D. Shan, MD, University of Alberta, Edmonton, Alberta, Canada

P64 Fireworks and Fatal Blast-type Trauma: A Forensic Pathologist Perspective
Lance Van Truong, DO, Arkansas State Crime Laboratory, Little Rock, Arkansas, United States of America

P65 The Hidden Burden of Alzheimer's Dementia: ABC Scoring in Autopsy Cases Across a 10-Year Period at a Large Academic Institution
Nicole Maddie, DO, New York Presbyterian Weill Cornell Medical Center, New York, New York, United States of America

P66 Trends in Publication Outcomes of Platform Presentations at National Association of Medical Examiners (NAME) Annual Meetings from 2013-2022
Elizabeth K. Lee, The University of Alabama at Birmingham, Birmingham, Alabama, United States of America

P67 Beyond Bullets: A Case Series of Diverse Suicide Methods in Belgium
Alexia Van Goethem, MD, Antwerp University Hospital, Antwerp, Belgium and Babette Van Rafeleghem, MD, Antwerp University Hospital, Antwerp, Belgium

P68 WITHDRAWN

P69 Lessons Learned in Forensic Pathology: A Practitioner's Experience in the Commonwealth Caribbean
Marisa Jacob-Leonce, MD, University of Rochester Medical Center, Rochester, New York, United States of America

P70 A Comparative Overview of Medicolegal Death Investigation in Pakistan and the United States
Muhammad Ahmad Faraz, MBBS, Post Graduate Medical Institute, Lahore, Lahore, Punjab, Pakistan

P71 WITHDRAWN

P72 Heat of the Moment: A 10-year Review of Investigative Insights into Environmental Hyperthermia Deaths in Harris County and Public Health Implications
Andy Bui, BS, Harris County Institute of Forensic Sciences, Houston, Texas, United States of America

P73 Sudden Death of Children with Septo-Optic Dysplasia Sequence: A Report of Three Cases
Daniella Garnica, University of New Haven, West Haven, Connecticut, United States of America

P74 Suicide by Electrocution using a Homemade Device: A Unique Presentation of a Rare Entity
Kennedi Lewellyn, OMS-I, West Virginia School of Osteopathic Medicine, Lewisburg, West Virginia, United States of America

P75 WITHDRAWN

P76 Silent Danger: The Fatal Consequences of Undiagnosed Brainstem Encephalitis
Camille F. Ng, MD, Loma Linda University Health, Loma Linda, California, United States of America

P77 Pink Skin and Purple Urine: The Effects of Hydroxocobalamin Administration in the Treatment of Cyanide Exposure
Griffin Phenegar, University of Wisconsin School of Medicine and Public Health, Madison, Wisconsin, United States of America

P78 Fatal Abdominal Pain: A Rare Case of Group A Streptococcal Phlegmonous Gastritis
Christopher Cormier, DO, Office of the Medical Investigator, State of New Mexico, Albuquerque, New Mexico, United States of America

P79 Moved to 8.4

P80 Investigating Small Airplane Crashes: A Medicolegal Death Investigator's Approach

Wendell Kyle McGlamery, D-AMBDI, GA P.O.S.T, DeKalb County Medical Examiner's Office, Decatur, Georgia, United States of America

P81 Silica Desiccants at Autopsy: An Uncommon Confounding Factor

Hunter Koster, MD, Loyola University Medical Center, Maywood, Illinois, United States of America

P82 Acute Disseminated Encephalomyelitis from Swine Flu

Kristen D'Angelo, M.D., Baylor University Medical Center, Dallas, Texas, United States of America

P83 Validation of the ARK Fentanyl II Assay: A More Specific and Reliable Alternative to the Immunalysis SERFIA for Clinical Fentanyl Screening

Omid Golestanian, MD, West Virginia University, Morgantown, West Virginia, United States of America

P84 Suicide by Chainsaw to the Leg

Fernanda Lameira, MD, VDH, Norfolk, Virginia, United States of America

P85 Aviation-Related Fatalities in Oklahoma (2015–2024): A Forensic Review of Crash Patterns, Demographics, and Contributing Factors

Ross James Miller, MD, OCME, Tulsa, Oklahoma, United States of America

P86 A Fungus Among Us: Cryptococcal Meningoencephalitis in an Apparently Immunocompetent Individual

Serina A. Williams, MD, Virginia Commonwealth University Health, Richmond, Virginia, United States of America

P87 WITHDRAWN

P88 Histiocytoid Cardiomyopathy and Congenital Valvular Stenosis: A Case Report of Infant Death

Helen Ellsworth, MD, Columbia University Medical Center, New York, New York, United States of America

P89 Nitro Boost: The Importance of Timing and Collection in Nitrous Oxide Medicolegal Death Investigations

Jolene J. Bierly, MSFS, NMS Labs, Horsham, Pennsylvania, United States of America

P90 Sudden Pediatric Death due to Undiagnosed Massive Gastric Dilation

Katrina Taylor, DO, ETSU, Johnson City, Tennessee, United States of America

P91 Suicidal Ingestion of Potassium Thiocyanate Presenting Clinically as Falsely Elevated Chloride: A Case Report

John Owode Agboola, MBBS, State University of New York Downstate Medical Center, Brooklyn, New York, United States of America

P92 Starvation Bone Marrow and the Complications of Severe Malnutrition

David John Hambly, BMedSci, MD, NSW Health Pathology, Forensic and Analytical Science Service, Forensic Medicine Newcastle, Newcastle, New South Wales, Australia

P93 WITHDRAWN

P94 An 8-Year-Old With... Wait...What? Acute Aortic Dissection, Available Resources, and Review of the Literature

Karen L. Kelly, MD, Forensic Pathology Services, Las Vegas, Nevada, United States of America and Ellen Hostetler, BA, The John Ritter Foundation, Los Angeles, California, United States of America

P95 This is What Happens When You Fight: A Case Review Regarding Manner Determination in a Firearm-Related Death

Malin Stewart, BFS, Virginia Office of the Chief Medical Examiner, Richmond, Virginia, United States of America and Ashley Seiler, BS, Virginia Office of the Chief Medical Examiner, Richmond, Virginia, United States of America

P96 Fatal Traumatic Brain Injury with Traumatic Axonal Injury from a Non-Penetrating Rubber Bullet: A Forensic Case Report

Devan C. Glensor, MA, University of Nevada, Reno School of Medicine, Reno, Nevada, United States of America

P97 Hidden Risks in the Pantry: Quantifying the Morphine Content in Washed and Unwashed Poppy Seeds

Tyra A. Banks, BA, TCU Burnett School of Medicine, Fort Worth, Texas, United States of America and

P97 Hidden Risks in the Pantry: Quantifying the Morphine Content in Washed and Unwashed Poppy Seeds

*Tyra A. Banks, BA, TCU Burnett School of Medicine, Fort Worth, Texas, United States of America and
Jeanine A. Williams, BSc, TCU Burnett School of Medicine, Fort Worth, Texas, United States of America*

P98 Results of Molecular Genetic Autopsy Screening

Edwin W. Naylor, PhD, NCGM, Apex, North Carolina, United States of America

P99 A Case of Fatal Measles Pneumonia in an Adult

Kelly Hynes, DO, Office of the Medical Investigator, Albuquerque, New Mexico, United States of America

P100 Medical Examiner Evaluation of Prehospital Needle Thoracostomy Accuracy and Success

Aaron A. Amundson, DO, Milwaukee County Medical Examiner, Milwaukee, Wisconsin, United States of America

P101 Decoding Congenital Hepatorenal Fibrocystic Syndromes Postmortem: An Exomic Study of Autosomal Recessive Polycystic Kidney Disease and Caroli's Syndrome

Yonatan Carl, MD, University New Mexico, Albuquerque, New Mexico, United States of America, Office Medical Investigator, Albuquerque, New Mexico, United States of America and Tricore Reference Laboratories, Albuquerque, New Mexico, United States of America

P102 Forensic Pathology Education: Do We Need an Alternative Pathway?

Thomas Gilson, MD, Cuyahoga County Medical Examiner's Office, Cleveland, Ohio, United States of America

P103 Pediatric Natural Deaths in a Small, Mixed Suburban and Rural Medical Examiner Jurisdiction

Danielle L. Mack, MD, University of Iowa Health Care Department of Pathology, Iowa City, Iowa, United States of America

P104 WITHDRAWN

P105 Case Report: A Heart Too Big for My Size

Christine M Gayle, PA(ASCP), F-ABMDI, Pierce County Medical Examiner's Office, Tacoma, Washington, United States of America

P106 Extrapulmonary Tuberculosis Manifesting as Postmenopausal Pyometra in a Chronically Ill Elderly Female

Hannah E. Xavier, MD, MS, University of Washington, Seattle, Washington, United States of America

P107 Mortui Vivos Docent: Forensic and Clinical Significance of Research on Diastatic Cranial Fractures in the Adult Neurocranium

Melinda L. Carter, MD, PhD, Edward Via College of Osteopathic Medicine, Auburn, Alabama, United States of America

P108 Assessing Viral Risks in Autopsy Practice: A Case of Donor-Derived Rabies

Carl J. Schmidt, MD, MPHxx, Lucas County Coroner's Office, Toledo, Ohio, United States of America and University of Michigan, Ann Arbor, Michigan, United States of America

P109 Barriers to Autopsy Acceptance in Muslim-Majority Populations: A Systematic Review of Cultural, Religious, and Educational Influences

Sara Al Harthi, MBBS, University of Washington, Seattle, Washington, United States of America

P110 Deaths Due to Drowning in the State of Maryland: A Retrospective Forensic Autopsy Study (2021-2023)

Jaylan Pratt, Forensic Medicine, University of Maryland, Baltimore, Maryland, United States of America

P111 Sutural Bones Masquerading as Inflicted Traumatic Skull Fracture in an Infant

Daniel Chadwick Butler, MD, Medical University of South Carolina, Charleston, South Carolina, United States of America

P112 WITHDRAWN

P113 A Lethal Instance of Spontaneous Coronary Artery Dissection Caused by Fibromuscular Dysplasia

Rosanna Drake, DO, Office of the Chief Medical Examiner, Baltimore, Maryland, United States of America

P114 Drowning and Elopement: A Retrospective Examination of Drowning Incidents in Children with Autism Spectrum Disorder

Joan Mealey-Kruger, F-ABMDI, Office of the Chief Medical Examiner, Baltimore, Maryland, United States of America

P115 Fatal Necrotizing Enteritis Due to Clostridium Perfringens in an Immunocompetent Child

Abhishek R. Shah, MD, Wayne County Medical Examiner's Office, Detroit, Michigan, United States of America

P116 Polymicrogyria and DDX3X Variants: Neuropathologic Findings in Two Forensic Autopsy Cases

Jolee Suddock, DO, Oklahoma Office of the Chief Medical Examiner, Oklahoma City, Oklahoma, United States of America

P117 Identification of Ectopic Variceal Bleed at Autopsy

Audra A. Kerwin, MD, Office of the Medical Investigator, Albuquerque, New Mexico, United States of America

P118 Moved to 9.1

P119 Central Pontine Myelinolysis as a Marker of Chronic Alcohol Use

Rachel Larsen, MS, PA (ASCP), D-ABMDI, Department of Laboratory Medicine and Pathology, Mayo Clinic, Rochester, Minnesota, United States of America and Southern Minnesota Regional Medical Examiner's Office, Rochester, Minnesota, United States of America

P120 Older Synthetic Cannabinoids Still Lurk: The Detection of MDMB-4en-PINACA via its Butanoic Acid Metabolite in Postmortem Toxicology Casework during 2024-2025

Kevin G. Shanks, MS, D-ABFT-FT, Axis Forensic Toxicology, Indianapolis, Indiana, United States of America

P121 Ketamine: It is not Just a Club Drug Anymore

Mary K. Schwerdt, MD, CT Office of the Chief Medical Examiner, Farmington, Connecticut, United States of America

P122 α -Pyrrolidinoisohexanophenone (α -PiHP)-Associated Deaths in Broward County from 2022-2023

Sierra Shoham, DO, Broward County Office of Medical Examiner and Trauma Services, Fort Lauderdale, Florida, United States of America

P123 A Review of Cases Involving Nitazene Detections

Stuart A.K. Kurtz, MS, D-ABFT-FT, Axis Forensic Toxicology, Indianapolis, Indiana, United States of America

P124 Characteristics of Hunting-Related Fatalities in Western Michigan (2015-2024)

Aaron Morgan, BS, Western Michigan University Homer Stryker, MD School of Medicine, Kalamazoo, Michigan, United States of America

P125 WITHDRAWN

P126 Is it a "Guy Thing?" Death, Diabetes, and Diabetic Ketoacidosis in the State of Georgia

Alexandra K. Medeiros, MD, Georgia Bureau of Investigation, Decatur, Georgia, United States of America and Medical College of Georgia, Augusta, Georgia, United States of America

P127 Propoxyphene was Taken off the Market Fifteen Years Ago, and Yet the Lab is Still Confirming it in Toxicology Casework

Laureen J. Marinetti, PhD, Axis Forensic Toxicology, Indianapolis, Indiana, United States of America

P128 Blood Gone Bitter: A Fatal Case of Methemoglobinemia Disguised as Carbon Monoxide Poisoning

Miramani Lenzini, OMSIII, Rocky Vista University, Parker, Colorado, United States of America

P129 Unintentional Injury Following Internal Bullet Strike on Weapon Components

Nicholas A. Boire, MD, ScM, Office of the Chief Medical Examiner, Baltimore, Maryland, United States of America

P130 Lethal Bowel Ischemia in a Teenager with Undiagnosed Median Arcuate Ligament Syndrome and Familial Hypercholesterolemia

Alex Penev, MD, PhD, King County Medical Examiners Office, Seattle, Washington, United States of America

P131 A Case of Cerebellopontine Angle Lipoma in a Sudden Death from Trauma: Etiology or Incidental Finding?

Alena Joseph, MD, St George's University, St George's, Grenada

P132 Autopsy Conclusions from the World's First Two Genetically Modified Porcine-to-Human Cardiac Xenotransplants

Lo Tamburro, MD, Department of Pathology; University of Maryland School of Medicine, Baltimore, Maryland, United States of America

P133 Project My Heart Your Heart: Pacemaker Recycling Program

Eric Puroll, BS, Michigan Medicine, Ann Arbor, Michigan, United States of America

P134 Airbag Components Causing Fatal Injury in Motor Vehicle Crashes

Madeleine Taddei, University of Arizona College of Medicine - Phoenix, Phoenix, Arizona, United States of America

P135 Cyanide Toxicity from Ingestion of Silverware Polish: A Case Study and Review of Suicide Trends in the Hmong Population of Marathon County, Wisconsin

Gino A Rancone, University of Wisconsin School of Medicine and Public Health, Madison, Wisconsin, United States of America

P136 A Year of Aortic Dissections: Demographics and Diagnostic Challenges from Autopsy Records in Georgia

William G. Anderson, OMS-IV, F-ABMDI, PCOM-GA, Atlanta, Georgia, United States of America and Clayton County Medical Examiner's Office, Jonesboro, Georgia, United States of America

P137 A Complication of Rigid Plate Fixation for Sternal Closure

Xin Zhang, MD, Department of Pathology, Indiana University, Indianapolis, Indiana, United States of America

P138 A Lethal Unexpected Toxic Megacolon with Rare Bacteremia

Thomas N. Wolfe, MD, East Tennessee State University, Johnson City, Tennessee, United States of America

P139 Beyond the Sternum: A Rare Case of Posterior Mediastinal Injury from Manual Cardiopulmonary Resuscitation

Beneshia Robinson, OMS-III, RN, MA, Pacific Northwest University of Health Sciences, Yakima, Washington, United States of America

P140 The Cost of Excess: Binge Drinking and Chronic Alcohol Use as Drivers of Youth Deaths

Sasha M. Ortiz-Cordero, MD, MS, King County Medical Examiner, Seattle, Washington, United States of America

P141 Anatomical Variations of the Human Skull at Autopsy: A Forensic Pathology–Anthropology Correlation

Emilee G Hine, BS, Butte County Coroner's Office, Oroville, California, United States of America

P142 Fatal Complex Self-Harming in the Setting of Psilocybin Intoxication: Suicide or Not?

Alfredo Eugene Walker, FRCPath, DMJ (Path), MBBS, University of Ottawa, Ottawa, Ontario, Canada and Eastern Ontario Regional Forensic Pathology Unit, Ottawa, Ontario, Canada

P143 A Missed Zebra: A Case Report of the Postmortem Diagnosis of Vascular Ehlers-Danlos Syndrome (vEDS)

Noelani-Mei Ascio, MD, MPH, HCA Florida Brandon Hospital, Brandon, Florida, United States of America

P144 Curriculum Improvement Through Autopsy Didactics with Standardized Materials

Samantha Engrav, Mayo Clinic, Rochester, Minnesota, United States of America

Exhibit Schedule

Exhibit Installation

Friday, October 17

1:00PM – 4:00PM

**Companies requiring additional installation time should contact NAME Exhibits Management for assistance. Early move-in may be subject to additional fees.*

Exhibitor Registration

Friday, October 17

10:00AM – 5:00PM

Saturday, October 18

7:00AM – 5:00PM

Sunday, October 19

7:00AM – 5:00PM

Monday, October 20

7:00AM – 5:00PM

Overall Exhibit Hall Hours

Friday, October 17

6:00PM – 8:00PM

(Exhibits Open During Opening Reception and Welcome Dinner; Exhibitors Welcome to Attend The Louis Jares Celebration of Life Dance Party from 8:00PM – 10:00PM)

Saturday, October 18

8:00AM – 3:45PM

Exhibit Hall Open: OPTIONAL

6:45AM – 8:00AM

Breakfast will be served in the Exhibit Hall

Sunday, October 19

8:00AM – 3:30PM

Exhibit Hall Open: OPTIONAL

6:45AM – 8:00AM

Breakfast will be served in the Exhibit Hall

Monday, October 20

8:00AM – 4:00PM

Exhibit Hall Open: OPTIONAL

6:45AM – 8:00AM

Breakfast will be served in the Exhibit Hall

Published Visiting Hours

Friday, October 17

6:00PM – 8:00PM

Saturday, October 18

10:05AM – 10:30AM

3:20PM – 3:45PM

Sunday, October 19

9:50AM – 10:15AM

3:05PM – 3:30PM

Monday, October 20

9:50AM – 10:20AM

3:35PM – 4:00PM

Exhibit Dismantling

Monday, October 20

4:00PM – 9:00PM

**You are only required to have personnel at the booth during published visiting hours; however, please note that the exhibit hall will be open throughout the day. Exhibitor(s) shall not initiate tear-down or abandon exhibit prior to the official Show closing time on the final Show Day without permission of NAME. If you need to shut down early, please contact Tara Snethen (tsnethen@thename.org) in advance of the meeting.*

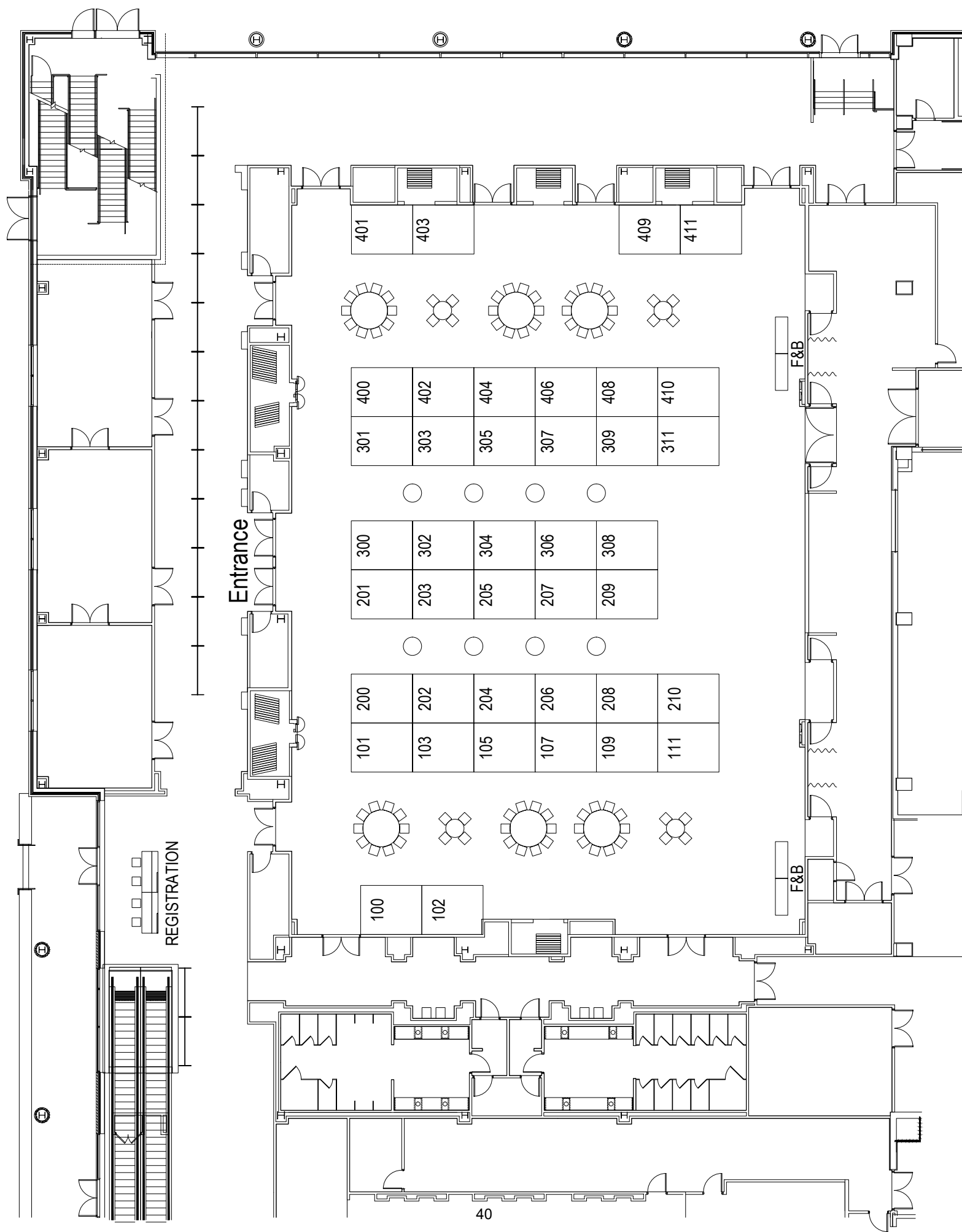

Entrance

REGISTRATION

F&B

F&B

EXHIBITOR DESCRIPTIONS

Advanced Detection Solutions, LLC (BOOTH # 304)

Post-mortem CT (PMCT) Turnkey solutions, that help: i) enhance traditional autopsies. Our PMCT solutions are modular a) Planning and Project management ; b) CT scanners (reconditioned and NEW) ; c) ForensicPACS™; d) Image sharing and Cloud Services ; e) CT Operations training ; f) Forensic imaging protocols, g) CT Trailers, and more. Low cost of ownership.

For more information visit: <https://detection-solutions.com/>

American Association of Pathologists' Assistants (AAPA) (BOOTH # 306)

The American Association of Pathologists' Assistants (AAPA) was founded in 1972 as a not-for-profit volunteer organization of allied health practitioners dedicated to the advocacy and advancement of the pathologists' assistant profession. The AAPA advocates, promotes and sustains the highest education and professional standards for the profession, for all associated educational training programs and for individual pathologists' assistants. It is our mission to provide our members with high quality, targeted continuing education (CE) opportunities, as well as professional development and leadership activities to include networking and support. Additionally, the AAPA strives to promote and support high quality standards within the scope of practice for pathologists' assistants in anatomic pathology, ensuring the provision of high quality patient care.

For more information visit: <https://www.pathassist.org/>

Autism BrainNet (BOOTH # 308)

Autism BrainNet is a collaborative network for the acquisition and distribution of donated postmortem brain tissue and other biologic samples for research on autism and related neurodevelopmental disorders.

For more information visit: <https://www.autismbrainnet.org/>

Axis Forensic Toxicology (BOOTH # 210)

Axis Forensic Toxicology helps MEs and coroners choose with confidence and stay with certainty. We're built to be an extension of your office—transparent in testing, direct in communication, and responsive to your needs. From full-case insight to consistent support, Axis removes barriers and eliminates hidden service tiers so you can stay focused on the work that matters.

For more information visit: <https://axisfortox.com/>

Axon Enterprise, Inc (BOOTH # 208)

Manufacturer of Conductive Electrical Devices.

For more information visit: <https://www.axon.com/>

CFSRE - The Center for Forensic Science Research & Education (BOOTH # 200)

The CFSRE conducts research, development, and new technology assessment, and delivers educational and training services for the forensic science community and beyond. Our educational programs include short-term placement for visiting scholars and researchers; partnerships to deliver degree programs at area universities; and continuing professional development for forensic scientists, law enforcement, and legal professionals.

For more information visit: <https://www.cfsre.org/>

Cohero Coroner/Medical Examiner Case Management Systems (BOOTH # 103)

Since 2014, Cohero has been delivering Coroner/Medical Examiner Case Management Systems to agencies across 11 states. Cohero's CMS is a fully web-based application that can be locally installed or cloud-hosted. Agency configurable workflow tools are complimented with intuitive search and reporting capabilities that are user friendly. All within a scalable system that can meet the needs of agencies serving populations from 1,000 to 10,000,000+.

For more information visit: <https://cohero.com/>

Cook County Medical Examiner (BOOTH # 207)

Medical Examiner having jurisdiction over Cook County, Illinois, including City of Chicago.

For more information visit: <https://www.cookcountyil.gov/agency/medical-examiners-office>

Crossroads Investigations (BOOTH # 411)

Crossroads Investigations helps medical examiners and coroners locate and notify next of kin quickly and discreetly - bringing closure to families and supporting your work. Our skip tracing process includes: gathering initial data from the examiner, restricted database and public record searches, social media and online investigations, and direct outreach to possible family members.

For more information visit: <https://xinvestigations.com/>

DeKalb County Medical Examiners Office & Forensic Medicine Associates, Inc. (BOOTH # 307)

DeKalb County Medical Examiners Office & Forensic Medicine Associates, Inc. (BOOTH # 307) The DeKalb County Medical Examiner's Office will promote medical examiner data modernization and fellowship recruitment. Our booth will focus on improved data systems and how it has positively impacted our office and increased efficiency. We will highlight our most recent data initiative; creating a public health data dashboard. We will inform MEOs how to capitalize on funding opportunities provided by the CDC Foundation. Additionally, DeKalb MEO recently obtained ACGME Accreditation and we will be actively recruiting for future fellows!!! :)

For more information visit: <https://www.dekalbcountyga.gov/medical-examiner/medical-examiners-office>

DNA Doe Project (BOOTH # 303)

Since 2017, DNA Doe Project has been a trailblazer in the development and deployment of investigative genetic genealogy (IGG) for difficult UHR cases. We ensure every Doe has an opportunity to be identified, regardless of circumstance or manner of death. As a non-profit, humanitarian organization DDP can leverage public, foundation, and corporate donations to provide funding assistance to our partner agencies.

For more information visit: <https://dnadoeproject.org/>

DoD/USU Brain Tissue Repository (BOOTH # 204)

The U.S. Department of Defense established the DoD/USU Brain Tissue Repository to advance traumatic brain injury (TBI) research. Our mission is to better understand the effects of traumatic brain injury and promote overall brain health of the warfighter. Using the best science, we support our service members and their families to help care for our military personnel after a head injury. Our scientists compare injured and uninjured brain tissue to better understand the effects of traumatic brain injury on brain health. We have discovered a unique scarring pattern that may explain post-blast symptoms like headache, memory issues, sleep problems, and post-traumatic stress.

For more information visit: <https://researchbraininjury.org/>

Dodge (BOOTH # 301)

The Dodge Company manufactures and distributes laboratory, clinical, and morgue supplies and equipment. We offer a wide range of disinfectants, preservatives, PPE, disposables, transport aids, body pouches and instruments. Innovative and prompt, Dodge strives to provide you with the best quality products and information.

For more information visit: <https://shop.dodgeco.com/>

ECU Health (BOOTH # 105)

ECU Health is expanding forensic services for their 29-county eastern North Carolina service area by investing in a new \$35 million 25,000 square foot facility that will be home to the new Eastern Regional Autopsy center. Anticipated opening is set for 2027. ECU Health is a mission-driven, 1,708-bed academic health care system serving more than 1.4 million people in 29 eastern North Carolina counties. The not-for-profit system is comprised of 13,000 team members, nine hospitals and a physician group that encompasses over 1,100 academic and community providers practicing in over 185 primary and specialty clinics located in more than 110 locations. The flagship ECU Health Medical Center, a Level I Trauma Center, and ECU Health Maynard Children's Hospital serve as the primary teaching hospitals for the Brody School of Medicine at East Carolina University. ECU Health and the Brody School of Medicine share a combined academic mission to improve the health and well-being of eastern North Carolina through patient care, education and research.

For more information visit: <https://careers.ecuhealth.org/>

Forensic Advantage Systems (BOOTH # 400)

We apply a commonsense approach to automating complex forensic science processes for Medical Examiners and Crime Labs. Learn more about Forensic Advantage @ forensicadvantage.com and follow us on LinkedIn.

For more information visit: <https://www.forensicadvantage.com/>

Forensic Fluids Laboratories (BOOTH # 401)

Forensic Fluids Laboratories' Oral Fluid drug testing is the quickest, most accurate and convenient matrix available. Oral Fluid levels are the closest to blood levels and do not require a needle poke. Oral Fluid is tested using the most accurate technology available.

For more information visit: <https://www.forensicfluids.com/>

Forensic Pathology Services (FPS) (BOOTH # 302)

Forensic Pathology Services is your nationwide partner for expert coverage in Medical Examiner and Coroner offices, offering locums work and private case support. With a team of 350+ certified professionals and experience serving 50+ offices, we ensure you're never without a Forensic Pathologist, MDI, PA, Technician, or Transcriptionist — whether for public service or private consultation.

For more information visit: <https://fpsllc.org>

Forensic Radiology Group LLC (BOOTH # 305)

A highly dedicated team of forensic radiologists that help enhance traditional autopsies. Our services include: a) Audit Services (Quality Assurance [CT image reads] ; b) Consultant Services (Non-primary reads) ; c) Consulting Projects (Education package ; Review systems) ; d) Forensic Reports (Primary CT image reads with findings reports) ; e) Skeletal Surveys ; f) Identifications, and more.

For more information visit: <https://forensicrodiologygroup.com/>

Grundium (BOOTH # 111)

Grundium is a global leader in digital pathology. With over 20 years of expertise in optics and imaging, we've engineered the Ocus® series of compact slide scanners. Ocus scanners enable rapid digitization of histological samples—whether evaluating cause of death, toxicologic pathology, or traumatic injury—facilitating remote consultations, streamlined case documentation, and evidence preservation. With unmatched reliability, crystal-clear imaging, and intuitive usability, Grundium delivers robust, affordable tools that support timely, accurate results.

For more information visit: <https://www.grundium.com/>

Health Data Explorer By Acoer (BOOTH # 406)

Health Data Explorer (HDE) is a platform built to streamline public health reporting, track trends like opioid-related deaths, automate data imports, and reduce administrative burden. With built-in advanced analytics and AI, HDE supports real-time insights and collaboration—empowering MDI and public health teams to detect trends and make data-driven decisions that improve public health outcomes.

For more information visit: <https://www.healthdataexplorer.io/>

HealthRFID (BOOTH # 100)

HealthRFID's BodyTracking platform provides real-time tracking of decedent movement and inventory, from autopsy benches to coolroom shelves, with real-time updates and integration with LIMS/CMS, for secure chain of custody. Our AnatomicalControl platform supports body donation programs to manage the end-to-end process, from donor registration through to cremation. Offering integrated anatomy lab inventory management while ensuring secure chain of custody and simplified auditing.

For more information visit: <https://healthrfid.com/>

LifeSign (BOOTH # 102)

Lifesign is a manufacturer of rapid diagnostics products. We offer a complete line of rapid immunoassays for Infectious disease, Women's Health, GI disorders. Our Status DS 10 panel drug screen and rapid Fentanyl tests are a valuable and cost effective tool to aid in post mortem investigations.

For more information visit: <https://lifesignmed.com/>

Lodox NA, LLC (BOOTH # 309/311)

Lodox Systems introducing eXero-dr- rapidly evident. North America's most trusted full-body, high-speed, digital radiology solution designed for forensic pathology. Lodox provides a time-saving, low-dose investigation of the entire body in less than 5 minutes. An imaging solution used around the world in multiple applications such as major Trauma, Mass Casualty, Pediatric, Bariatric, Bone Scans, and Forensic Medico-Legal Investigations. For more information visit: <http://lodox.com/forensics/>

Micro Distributing (BOOTH # 404)

Micro Distributing is drug and alcohol testing company in business for 25 years. We are a nationwide distributor of innovative instant drug testing kits for urine, oral fluid and hair (NEW !). We are also a full service Third Party Administrator of drug testing programs for DOT, non-DOT workplace, criminal justice, behavioral health, and healthcare agencies. We offer certified laboratory testing, medical review officer (MRO), nationwide collection site network, live remote test proctoring, random selection and scheduling, drug test management software, federal and state law compliance, and training.

For more information visit: <https://www.micro-distributing.com/>

MobiMedical (BOOTH # 402)

Locally owned manufacturer of hospital morgue and pathology equipment. Headquartered in Columbia, South Carolina. We manufacture our own Coolers, Body Racks, Trays, Scissor Lifts, Grossing Stations, Autopsy Stations and Sinks and also offer Portable X-Ray Machines, Power Mortuary Cots and more! We can also customize your equipment to meet your facility needs!

For more information visit: <https://medical-stretchers.com/>

Mopec (BOOTH # 203)

Mopec is the trusted partner for forensic professionals who demand safety, reliability, and readiness at every step. As the only provider of fully integrated morgue and autopsy systems, we bring together ergonomic workstations, our patented SafeDraft™ ventilation, Mortech advanced refrigeration, and Guardian Systems™ mobile morgue trailers into one seamless solution. Designed to protect your staff, streamline workflows, and prepare facilities for any challenge, Mopec solutions go beyond equipment to deliver confidence in every detail. Whether in daily operations or during mass casualty events, our team provides the expertise, service, and support needed to ensure forensic facilities run safely, efficiently, and without interruption.

For more information visit: <https://www.mopec.com/>

MWL Architects (BOOTH # 209)

McClaren, Wilson & Lawrie, Inc. is an architectural firm internationally recognized for the planning and design of forensic laboratory, pathology and law enforcement facilities. MWL offers master plans, needs assessments, site feasibility studies, budget development and design services. With offices nationwide, MWL has completed nearly 350 public safety and 180 forensic facilities in 46 states.

For more information visit: <https://mwlarchitects.com/>

NCGM Inc (BOOTH # 205)

NCGM, Inc. facilitates the integration of Genomics into mainstream diagnostics providing a range of genetic testing solutions. NCGM's molecular autopsy benefits most sudden or unexplained infant, childhood, or adult death. It is estimated that 3-6% of sudden or unexplained infant deaths are attributable to disorders of fatty acid metabolism, 3-6% to other inborn errors of metabolism, and 25% to congenital heart defects.

For more information visit: <https://www.ncgmus.com/>

NMS Labs (BOOTH # 201/300)

NMS Labs delivers world-renowned forensic and clinical testing through an unmatched menu of toxicology and drug identification services. Backed by over 400 highly trained professionals, NMS Labs provides comprehensive panels and targeted testing options with industry-leading quality, scientific expertise, and rapid turnaround times to meet your most demanding needs.

For more information visit: <https://nmslabs.com/>

Othram, Inc. (BOOTH # 206)

Empowering the justice system to deliver better answers for victims and their families through the innovation, development and deployment of advanced technology solutions.

For more information visit: <https://othram.com/>

Scimedico, LLC (BOOTH # 107)

Scimedico's Whole Pathology Solutions (WPS) improves operational efficiency by uniting compliance, equipment management, and digital pathology into one integrated platform. Complilab.com centralizes service tracking, equipment lifecycle data, and compliance documentation to streamline lab operations. WPS supports full equipment lifecycle management—from planning and installation to preventive maintenance and repair. Integrated digital pathology tools enhance workflow with image capture, archiving, and collaboration, supporting accuracy and productivity across pathology environments.

For more information visit: <https://www.scimedico.com/>

Silikal America (BOOTH # 109)

Silikal flooring is a seamless, non-porous resin system engineered for hygienic environments. Its smooth surface prevents dirt, bacteria, and liquids from penetrating, making it easy to clean and sanitize. Unlike tile or grout systems, there are no joints where germs can hide. Ideal for food, medical, and industrial settings, Silikal ensures superior hygiene and lasting protection.

For more information visit: <https://www.silikalamerica.com>

Solvita (BOOTH #403)

Solvita comes from “sol” meaning sun and “vita” meaning life. As sunlight nurtures new life, we take the donor gift and transform it into new hope, bringing the light of healing to patients around the globe in need of tissue transplants.

For more information visit: <https://solvita.org/>

SPIRE Integrated Solutions | CSI Jewett (BOOTH # 101)

Spire Integrated Solutions manufactures the CSI Jewett brand of Morgue and Autopsy Equipment. MADE IN THE USA.

For more information visit: <https://www.spire-is.com/products/healthcare-products/morgue-autopsy-equipment/>

The Sudden Unexplained Death in Childhood Foundation (BOOTH # 202)

The Sudden Unexplained Death In Childhood (SUDC) Foundation is the only organization worldwide that raises awareness, funds research, and supports those affected by SUDC. The SUDC Foundation is dedicated to supporting medical examiners and coroners who are actively investigating SUDC cases by removing barriers to access postmortem genetic testing, ensuring both professionals and affected families have the support and resources needed for a thorough and comprehensive investigation. The SUDC Foundation provides all support and services at no cost to the families and medical professionals it serves.

For more information visit: <https://sudc.org/>

Thermo Fisher Scientific (BOOTH # 409)

Thermo Fisher Scientific is the world leader in forensic DNA testing and has supported the criminal justice community for more than 25 years. Our comprehensive forensic solutions empower laboratories at every stage of analysis—from rapid DNA processing to advanced toxicology workflows.

For more information visit: <https://www.thermofisher.com/us/en/home.html>

Tissue Techniques Pathology Labs, LLC (BOOTH # 410)

Tissue Techniques Pathology Labs, LLC is a fully licensed CLIA Laboratory, providing technical services. We are dedicated to providing the highest quality product with quick turnaround times. All personnel are certified Histologic Technicians and have many years of experience in all areas of the laboratory.

For more information visit: <http://www.tissuetechpathology.com>

VertiQ Software LLC (BOOTH # 408)

Our CME-Moon software is a powerful, integrated solution designed to streamline your case and workflow management. It offers robust reporting and statistical capabilities, all within a 100% web-based application accessible from any mobile device. Whether you prefer an in-house installation or our fully managed hosted environment, CME-Moon adapts to your needs. Ask about our new mass fatality and LIMS modules!

For more information visit: <https://vertiq.com/>

NAME 59th Annual Meeting
Louisville Marriott Downtown – Louisville, Kentucky
October 17 – 21, 2025

NOTES

MILTON HELPERN LAUREATE AWARD



THE NATIONAL ASSOCIATION OF MEDICAL EXAMINERS

The National Association of Medical Examiners began, as many great organizations do, from the dreams, ideas and wisdom of a few farsighted, socially conscious individuals. Back in 1965, Milton Helpern recognized the need for the nation's Medical Examiners to share their knowledge, expertise and experience in order to improve the medicolegal investigation of death in this country.

He discussed this concept with Richard Childs, the Executive Director of the National Municipal League, and a group of his close colleagues, Ali Hameli, Chief Medical Examiner, State of Delaware, Leslie Lukash, Chief Medical Examiner, Nassau County, New York, and Joseph Spellman, Chief Medical Examiner, City of Philadelphia. In the spring of 1966, these individuals formed a planning committee in order to bring Doctor Helpern's concept to reality. This group became the foundation and heard of what was later to become the National Association of Medical Examiners.

Through the dedication and efforts of these five men, N.A.M.E. was incorporated in August, 1966. Subsequently they invited Chief Medical Examiners throughout the country to meet in Doctor Helpern's Office. As a result of that meeting, an interim steering board was formed which later paved the way for the first annual membership meeting held at the Knickerbocker Hotel in Chicago in February, 1968.

NAME 59th Annual Meeting
Louisville Marriott Downtown – Louisville, Kentucky
October 17 – 21, 2025

JAMES R. GILL, M.D.



Dr. James Gill is the Chief Medical Examiner of Connecticut, a past President of the National Association of Medical Examiners (NAME), and past Chair of the Forensic Pathology Committee of the College of American Pathologists (CAP). He is a practicing forensic pathologist and has faculty medical school appointments at Yale, University of Connecticut, and Quinnipiac University. He did his pathology training at Yale and Memorial Sloan-Kettering Cancer Center and his forensic pathology fellowship at the New York City Office of Chief Medical Examiner under Charles Hirsch. Prior to Connecticut, he was the Deputy Chief Medical Examiner for Bronx County. He has published two textbooks and over 140 scientific articles and book chapters on a variety of forensic pathology topics. He has interests in drug intoxication deaths, infectious disease, fatal complications of therapy, and proper death certification.

OPTIONAL MEETINGS/ACTIVITIES

OPTIONAL THE LOUIS JARES CELEBRATION OF LIFE DANCE PARTY [NOT CME]

Date: Friday, October 17, 2025

Time: 8:00 PM – 10:00 PM (Immediately Following the Welcome Reception/Dinner)

Cost: FREE

Join us as we honor the life, laughter, and legacy of our beloved friend and colleague, Louis Jares.



Lou gave generously of his time and talent to NAME supporting our first fully virtual meeting in 2020 and continued as a trusted force behind so many of our Annual Meetings. Lou was much more than tech support and guidance - he gave us friendship, wisdom, and humor that could light up even the most chaotic meeting event day.

Lou loved a good laugh, a great song, and a room full of joy. So, what better way to celebrate his life than with music, movement, and memories. This dance party is our way of keeping his spirit alive just as he would want it—full of energy, kindness, and a dash of ridiculousness.

Wear your dancing shoes, bring your favorite Lou story, and get ready to raise a glass and let loose. This one's for him.

Forever remembered. Forever missed. Forever dancing.

OPTIONAL NAVIGATING GOVERNMENTAL AFFAIRS AND ADVOCACY – BREAKFAST BRIEFING [NOT CME]

Date: Saturday, October 18, 2025

Time: 7:00 AM – 8:00 AM

Cost: \$30

Are you interested in advocating for change in your community but aren't sure where to start? Join us for "Breakfast Briefing: Navigating Governmental Affairs and Advocacy," an informal breakfast panel discussion that will

guide NAME members on how to best engage with state and local government representatives. Learn strategies for building relationships with elected officials, communicating effectively with policymakers, and advocating for issues that matter to your community and the forensic profession. Whether you are a seasoned advocate or new to advocacy, this breakfast meeting will provide valuable insights and resources to help you make a difference in your community. Join us for this informative and empowering session on advocating for death investigation! Preregistration is required. Breakfast will be available outside of the meeting room.

OPTIONAL NAME FOUNDATION THOMAS NOGUCHI, MD LECTURE "CORONER TO THE STARS"

CME: 1.5

Date: Saturday, October 18, 2025

Location: Louisville Marriott Downtown

Time: 8:00 PM to 10:00 PM



On behalf of the NAME Foundation Board of Trustees, we would like to announce the 10th annual evening NAME Foundation Thomas Noguchi, MD Lecture, to be presented in conjunction with the NAME Annual Meeting in Louisville, Kentucky on Saturday, October 18th from 8 to 10 PM.

We are pleased to welcome Director & Producer Ben Hethcoat, who will share insights into his creative journey and the process behind making the film.

Coroner to the Stars chronicles the extraordinary journey of Dr. Thomas Noguchi, the former Los Angeles County Chief Medical Examiner-Coroner whose groundbreaking autopsies forever shaped American culture. From Marilyn Monroe and Robert Kennedy to Sharon Tate and Natalie Wood, Noguchi's outspoken expertise pushed forensic science into the spotlight—even as Hollywood elites and political adversaries sought to silence him. A Japanese immigrant who unwittingly rose to fame in a city driven by stardom, Noguchi's fearless pursuit of truth often placed him in the cross hairs of controversy.

NAME 59th Annual Meeting
Louisville Marriott Downtown – Louisville, Kentucky
October 17 – 21, 2025

Please note that this year attendance is FREE to ALL NAME Annual Meeting attendees. You will be required to wear your meeting name badge.

Absolutely NO photography, videography or audio recordings will be permitted. Anyone in violation will be immediately escorted out of the building and their recording device will be confiscated

**OPTIONAL 27th RIGOR RUN/WALK
[NOT CME]**

Date: Sunday, October 19, 2025
Time: 6:00 AM – 8:00 AM
Cost: \$30.00 per person

The NAME Rigor Run/Walk will be approximately 3 miles. The route will start and end at the meeting hotel. Registrants for the Rigor Run/Walk will receive a terrific T-shirt. Runners and walkers can go to the Sunday morning breakfast after returning to the hotel. Note: T-shirts will be available on a first come first serve basis. There will be shirts in sizes S, M, L and XL.

**OPTIONAL 30th ANNUAL RANDY HANZLICK
MEMORIAL CADAVER OPEN GOLF TOURNAMENT
[NOT CME]**

Date: Sunday, October 19, 2025
Time: 11:00 AM
Cost: \$95 per player



The 30th Annual Randy Hanzlick Memorial Cadaver Open Golf Tournament will be held at **Champions Pointe** <https://www.cbcp golf.com/champions-pointe-course-overview/>. TaylorMade/Callaway rental sets are available for \$60. If you have questions about the golf tournament, please contact David Winston at dcwinston25@gmail.com. Team pairings will be announced a few weeks prior to the meeting. Please bring \$10 cash for prize money for the winning team members and closest to the pin. **The deadline for signing up for the Cadaver Open is Tuesday, September 15, 2025.**

**OPTIONAL LOUIS JARES MEMORIAL BRING YOUR
OWN STORIES EVENT
[NOT CME]**

Date: Sunday, October 19, 2025
Time: 6:00 PM – 8:00 PM
Cost: FREE

Stories from locals affected by donation. A chance to share your stories on the importance and impact of donation on the areas that you serve. What can your local organ/tissue/eye bank do to support your processes? How can we work better together? RSVP Required. RSVP to Catherine Miller at cmiller11@email.mmc.edu.

**OPTIONAL LEARN TO LEAD WITH INTEGRITY AND
INNOVATION FROM FORENSIC PATHOLOGY
LEADERS – BREAKFAST WORKSHOP**

CME: 1
Date: Monday, October 20, 2025
Time: 7:00 AM – 8:00 AM
Cost: \$30

Our greatest forensic leadership resources are our current and past leaders. Develop a deeper understanding of how our forensic leaders approach challenges and inspire others by attending this moderated interactive question and answer breakfast workshop. Previously titled the Chief's Breakfast, this session will highlight the experiences of three successful leaders in forensic pathology. Topics that will be explored include administration, personnel issues, program innovations, budget management, leadership training, problem solving, and effective leadership during crisis. Former and current forensic pathology leaders are also invited to attend to share their experiences and interact with attendees who are interested in becoming future leaders. Preregistration is required. Breakfast will be available outside of the meeting room.

**OPTIONAL VOICES: AMPLIFY, ELEVATE,
CELEBRATE LUNCHEON**

CME: 1
Date: Monday, October 20, 2025
Time: 12:00 PM – 1:30 PM
Cost: \$70.00 per person

NAME aims to foster a deeper understanding and appreciation of different perspectives, creating an environment where everyone feels valued and empowered. As medicolegal professionals, it is important that we recognize the knowledge and skills of people from all backgrounds to offer us fresh points of views when interacting with our community and each other. The Luncheon will feature a panel of NAME members across career stages and practice settings discussing timely topics related to obstacles faced in practice and workforce development related to identities.

Please join us Monday, October 20, 2025, from 12:00 PM – 1:30 PM at Louisville Marriott Downtown, Louisville, Kentucky. Voices: Amplify, Elevate, Celebrate Luncheon is open to all members of NAME. Don't miss this

NAME 59th Annual Meeting
Louisville Marriott Downtown – Louisville, Kentucky
October 17 – 21, 2025

opportunity to connect with colleagues and celebrate the differences that make our profession strong.

Register early as space is limited!

**OPTIONAL BUSINESS OF FORENSIC PATHOLOGY
BREAKFAST**

CME: 1

Date: Tuesday, October 21, 2025

Time: 7:00 AM – 8:00 AM

Cost: \$30.00 per person

The practice of forensic pathology is changing, and increasingly forensic pathologists are running their own practices. These practices may include private autopsy services, consulting forensic services, or locum tenens forensic pathology services. All of these require not only knowledge of how to start a business, but also how to navigate the field of forensic medicine and the medicolegal system. This breakfast will provide a panel of forensic pathologists in an interactive session who are willing to share their experiences in practical steps. Pre-registration is required.

NOW OFFERING:

**RAPID DNA SERVICE
FOR MEDICAL EXAMINERS AND CORONERS**

Send in a Sample. Get Rapid Results.



**FAST
LOW COST
STRONG SUCCESS**

**Talk to a specialist
about your case:
+1 (855) 508-6244
www.ANDE.com/UHR**



**HELP BRING JUSTICE TO
UNSOLVED COLD CASES**



Season of Justice is one of the nation's only 501(c)3 nonprofits dedicated to funding advanced DNA testing to help move cold cases closer to being solved.

Every year, **thousands of violent homicides and sexual assaults go unsolved** because agencies lack the resources for advanced forensic testing. Your support can help **bring resolution to victims and families** and accountability to violent offenders through the power of science and advanced DNA testing.

With your support, you can help:

- **Fund cutting-edge DNA testing to identify violent offenders.**
- **Equip investigators to close cold cases long thought unsolvable.**
- **Deliver long-overdue answers and justice to families still waiting for answers.**



Donate today to solve cold cases
Your gift turns science into justice



@seasonofjustice
info@seasonofjustice.org
www.seasonofjustice.org

**TO LEARN
MORE**



NAME2026

Annual Meeting



SAVE
the **DATE**

OCTOBER 16 – 20, 2026



Join us next year in
Kansas City, Missouri

**SHERATON KANSAS CITY HOTEL
AT CROWN CENTER**



Chat with NMS Labs Toxicologists

Visit us at booth #201 to get answers and insights from members of the NMS Labs Forensic Toxicology Team. Stop by during your scheduled breaks for a chat.

Saturday, October 18

- 10:05 AM - 10:30 AM
- 3:20 PM - 3:45 PM

Sunday, October 19

- 9:50 AM - 10:15 AM
- 3:05 PM - 3:30 PM

Can't make it but still want to connect with NMS Labs? Scan here to request a follow up call.

